

SUGGESTED PANEL CUTOUT

MATERIALS

BODY:
Polyamide 6/6 (PA66), UL94 V-2

ACTUATOR:
Polyamide 6/6 (PA66), UL94 V-2

SEALING MEMBRANE:
Polyvinyl Chloride (PVC)

SPRING:
Phono wire

MOBILE CONTACT BAR:
Copper

CONTACT PADS:
Silver Clad Copper

RIFETS:
Copper

TERMINALS:
Brass

SPECIFICATIONS

FUNCTION:
2P2T ON-OFF-ON

RATINGS:
ANSI/UL 508 and CAN/CSA C22.2 No.14 (E198908):
20A 125VAC [cUlrua]
15A 277VAC [cUlrua]
2HP 110/250VAC [cUlrua]

CONTACT RESISTANCE:
Initial: 50mΩ Max.
Electrical Life: 6,000 Cycles [cUlrua]

TEMPERATURE:
Operating: -20°C to 55°C [cUlrua]

INGRESS PROTECTION:
IP54



COLORS AND MARKINGS

BODY COLOR:
Black

ACTUATOR COLOR:
Black

MARKING:
None

MARKING COLOR:
None

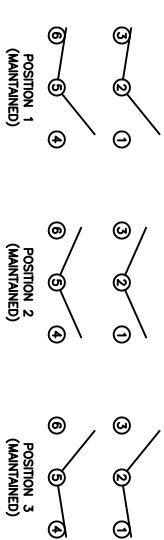
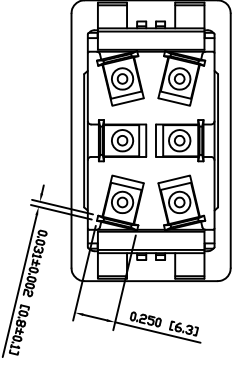

SCHEMATIC

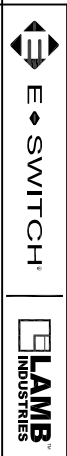

RWW46D1100

DATE: DECEMBER 9, 2009

ACTUATOR	B	10/09/28	CAB
BODY	A <td>09/06/15 <th>CAB</th> </td>	09/06/15 <th>CAB</th>	CAB
COLORS	A <td>10/03/07 <th>CAB</th> </td>	10/03/07 <th>CAB</th>	CAB
MATERIALS	C <td>10/03/07 <th>CAB</th> </td>	10/03/07 <th>CAB</th>	CAB
SPECIFICATIONS	C <td>10/03/07 <th>CAB</th> </td>	10/03/07 <th>CAB</th>	CAB
REFERENCE	REV. <td>DATE <td>BY</td> </td>	DATE <td>BY</td>	BY

THE INFORMATION CONTAINED IN THIS DOCUMENT IS PROPRIETARY TO E-SWITCH AND IS NOT TO BE COPIED OR TRANSMITTED

CONNECTED SPECIFICATIONS	B
INITIAL RELEASE	A
DESCRIPTION	REV.

INCHES [MILLIMETERS]	POB00247	10/12/09	CAB
GENERAL TOLERANCES	POB00051 <td>09/08/05 <th>CAB</th> </td>	09/08/05 <th>CAB</th>	CAB
SCALE	FOR <td>DATE <td>DRAWN BY </td></td>	DATE <td>DRAWN BY </td>	DRAWN BY

PROJECTION DRAWING NUMBER: 34-RWW46D1100

REVISION: B