

PLEASE CHECK WWW.MOLEX.COM FOR LATEST PART INFORMATION

Part Number: [11-18-4115](#)
Status: **Active**
Description: Conductor Anvil

Documents:

[RoHS Certificate of Compliance \(PDF\)](#)

General

Product Family	Application Tooling
Series	T1118
Comments	See Tooling Specification (PDF) Above
Function	Cutter
Geographic Area	Global
Level of Automation	Semi-Automatic
More Detailed Tech Information	applicationtooling@molex.com
Product Name	N/A
Survey	www.molex.com//review/apptool_survey.html
Tool Type	Anvil
UPC	800753181342

Physical

Net Weight 4.040/g

Material Info

Old Part Number 60712 15

Reference - Drawing Numbers

Application Tooling Documents ATS-STANDARD-PARTS

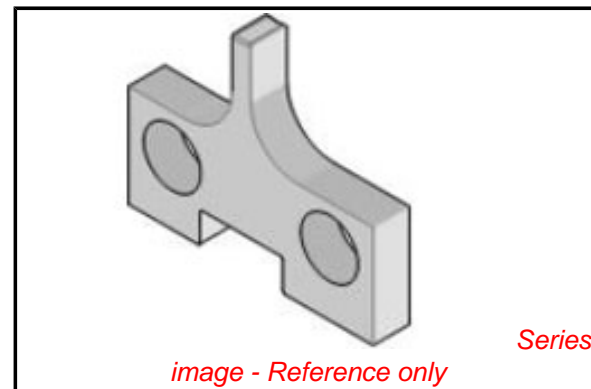

EU RoHS

**ELV and RoHS
Compliant**

REACH SVHC

Not Reviewed

Low-Halogen Status

Not Reviewed

China RoHS



**Need more information on product
environmental compliance?**

Email productcompliance@molex.com
 For a multiple part number RoHS Certificate of
 Compliance, [click here](#)

Please visit the [Contact Us](#) section for any
 non-product compliance questions.

Search Parts in this Series

[T1118Series](#)

Use With

[11-18-2022](#) , [11-18-3021](#) , [63888-1000](#) ,
[63888-1070](#)

PLEASE CHECK WWW.MOLEX.COM FOR LATEST PART INFORMATION