

PART NUMBER	CURRENT RATING (A)	BODY COLOR	RATED VOLTAGE
0293020.MXJ	20	LIGHT BLUE	32V
0293030.MXJ	30	PINK	
0293040.MXJ	40	GREEN	
0293050.MXJ	50	RED	
0293060.MXJ	60	YELLOW	
0293070.MXJ	70	BROWN	
0293080.MXJ	80	BLACK	
0293100.MXJ	100	BLUE	

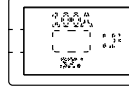
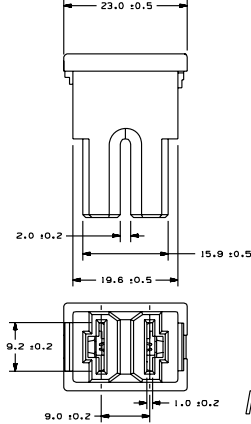
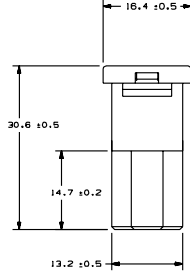

% OF RATED CURRENT	OPENING TIME	
	MIN	MAX
110%	14,400 SEC.	-
200%	5 SEC.	100 SEC.
350%	0.2 SEC.	7 SEC.
600%	0.04 SEC.	1 SEC.

METRIC

UNLESS OTHERWISE SPECIFIED, DIMENSIONS ARE IN MILLIMETERS. DIMENSIONS IN BRACKETS [ ] ARE INCHES. DIMENSIONS DO NOT INCLUDE PLATING. UNLESS OTHERWISE SPECIFIED, DIMENSIONS DO NOT INCLUDE PLATING.

CPK DENOTES CPK DIMENSIONS. MINIMUM CPK VALUE DENOTES A CHARACTERISTIC THAT PROVIDES AN INDICATION OF THE VARIATION OF THE MEASUREMENT AND TRACING TO BE SET FORTH IN LITTELFUSE INSPECTION INSTRUCTIONS

CP DENOTES CP DIMENSIONS. MINIMUM CP VALUE DENOTES A CHARACTERISTIC THAT PROVIDES AN INDICATION OF THE VARIATION OF THE MEASUREMENT AND TRACING TO BE SET FORTH IN LITTELFUSE INSPECTION INSTRUCTIONS. SHOWN ON DRAWING AND INITIALLY LOGGED TO ALLOW FOR MAXIMUM TOOL LIFE

NO COMPONENT NO		DESCRIPTION	QTY/M	U/M
BILL OF MATERIAL				
COPIES TO				
MATERIAL SPEC				
LTR	DATE	REVISION	CHK	APD
A	06/14/09	0007828R-RELEASE GMB		
B	03/26/10	029301 RELEASE 0293020.MXJ 0293030.MXJ 0293040.MXJ 0293050.MXJ 0293060.MXJ 0293070.MXJ 0293080.MXJ GMB		

TITLE: SLOW BLOW FUSE AS TYPE

REVISION DWG. NO. B OL-0293000.MXJ

**Littelfuse**  
 A  
 DET. PLAIN, ILLINOIS 60411

DATE	SCALE	DATE	SCALE
06/14/09	7:1	06/14/09	7:1
DATE	SUPER DR	DATE	SUPER DR
DATE	FINISH GOOD WT	DATE	FINISH GOOD WT

TOLERANCE UNLESS OTHERWISE SPECIFIED IS:  
 ONE PLACE DEC +/- .4  
 TWO PLACE DEC +/- .25  
 THREE PLACE DEC +/- .100  
 ANGULAR +/- .1°