

THIS DRAWING IS UNPUBLISHED. RELEASED FOR PUBLICATION
 © COPYRIGHT - By - ALL RIGHTS RESERVED.

LOC		DIST		REVISIONS			
P	LTR	DESCRIPTION		DATE	DWN	APVD	
CM	00	G		REVISED PER ECO-12-007612	03AUG12	KH	SM

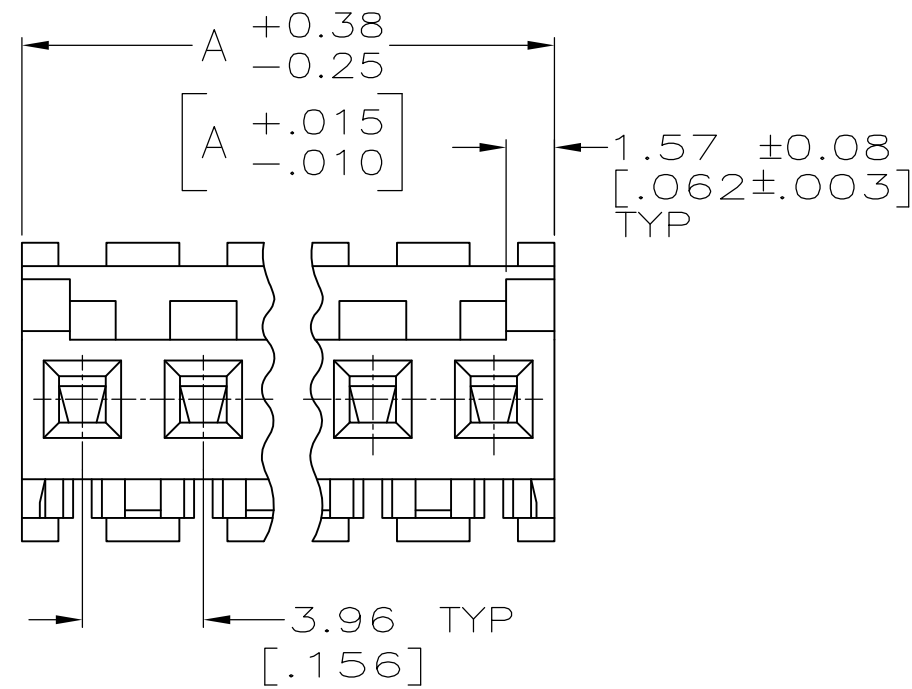
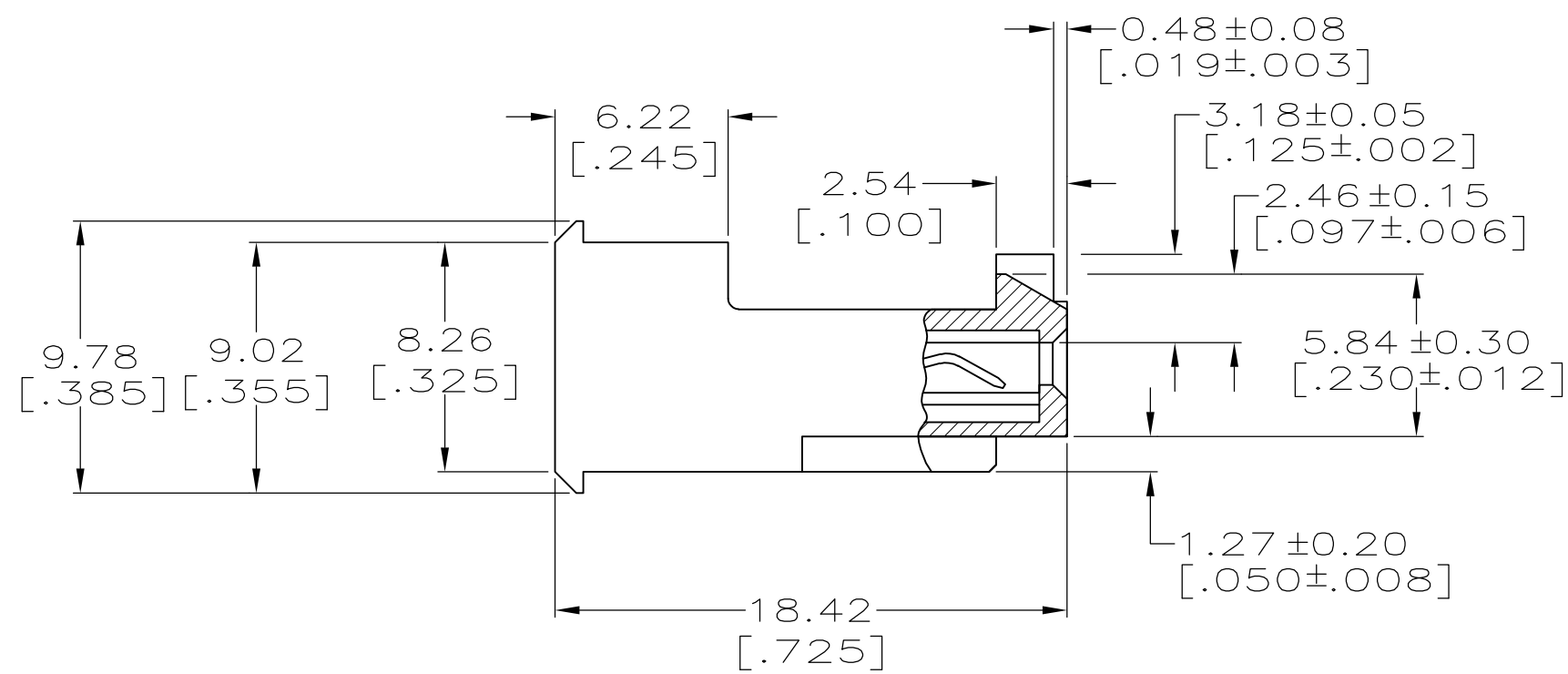
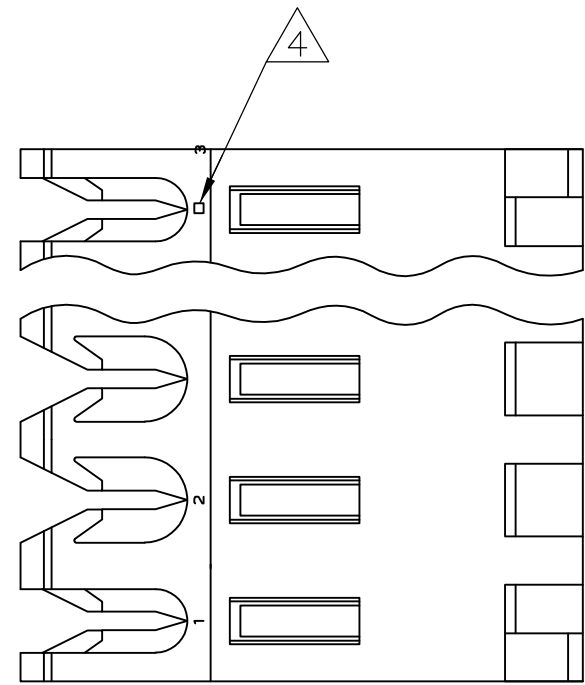

- 1 MATERIAL:
 CONNECTOR - NYLON UL94V-2.
 CONTACTS - 0.30[.012] THICK COPPER ALLOY.
 PLATING - 0.00076[.000030] GOLD THK OR 0.00008[.000003] MIN THK GOLD FLASH OVER 0.00068[.000027] THK PALLADIUM NICKEL, PER TE CONNECTIVITY'S DISCRETION. IN CONTACT AREA. 0.00203[.000080] MIN THICKNESS BRIGHT TIN LEAD IN SLOT AREA FOR 647479-2 THRU 1-647479-2 OR MATTE WHISKER MITIGATED TIN IN SLOT AREA FOR 3-647479-2 THRU 5-647479-4 OVER NICKEL UNDERPLATE.
- 2 CONTACTS ACCEPT 18 AWG WIRE WITH 2.41[.095] MAX INSULATION DIAMETER.
- 3 CONTACTS MUST ACCEPT 1.14 0.03[.045] POST AND REMAIN LOCKED IN POSITION.
- 4 IDENTIFICATION NUMBER FOR LAST CIRCUIT MAY TIN-LEADT APPEAR ON ALL ASSEMBLIES.
- 5 DIMENSIONS IN BRACKETS ARE IN INCHES.
- 6 HOUSING FEATURES ARE: FEED-THRU WITH LOCKING RAMP AND POLARIZING TAB.
- 7 OBSOLETE PARTS: OBSOLETE CIS STREAMLINING PER D.RENAUD/D.SINISI
- 8 ORANGE COLOR STRIPE ON HOUSING (NOT SHOWN) MAY RUN DOWN BETWEEN RIBS.

TIN	47.55[1.872]	12	4-647479-2	
TIN	43.59[1.716]	11	4-647479-1	
TIN	39.62[1.560]	10	4-647479-0	
TIN	35.66[1.404]	9	3-647479-9	
TIN	31.70[1.248]	8	3-647479-8	
TIN	27.74[1.092]	7	3-647479-7	
TIN	23.77[.936]	6	3-647479-6	
TIN	19.81[.780]	5	3-647479-5	
TIN	15.85[.624]	4	3-647479-4	
TIN	11.89[.468]	3	3-647479-3	
TIN	7.92[.312]	2	3-647479-2	
TIN-LEAD	47.55[1.872]	12	1-647479-2	
7 SUPERSEDED	TIN-LEAD 43.59[1.716]	11	1-647479-1	
	TIN-LEAD 39.62[1.560]	10	1-647479-0	
7 SUPERSEDED	TIN-LEAD 35.66[1.404]	9	647479-9	
7 SUPERSEDED	TIN-LEAD 31.70[1.248]	8	647479-8	
7 SUPERSEDED	TIN-LEAD 27.74[1.092]	7	647479-7	
7 SUPERSEDED	TIN-LEAD 23.77[.936]	6	647479-6	
	TIN-LEAD 19.81[.780]	5	647479-5	
	TIN-LEAD 15.85[.624]	4	647479-4	
	TIN-LEAD 11.89[.468]	3	647479-3	
	TIN-LEAD 7.92[.312]	2	647479-2	
	FINISH	DIM A	NO. OF CIRCUITS	PART NO.

THIS DRAWING IS A CONTROLLED DOCUMENT.		DWN K. WHITAKER 15-MAR-04	TE Connectivity			
DIMENSIONS: mm [INCHES]		CHK D. BOSSI 15-MAR-04				
TOLERANCES UNLESS OTHERWISE SPECIFIED:		APVD D. BOSSI 15-MAR-04	NAME MTA-156 CONNECTOR ASSEMBLY, 18 AWG, STANDARD			
0 PLC ± - 1 PLC ± - 2 PLC ± - 3 PLC ± - 4 PLC ± - ANGLES ± -		PRODUCT SPEC 108-1051	SIZE A2	CAGE CODE 00779	DRAWING NO C=647479	RESTRICTED TO -
MATERIAL 1	FINISH 1	APPLICATION SPEC 114-1020	WEIGHT -	SCALE 4:1	SHEET 1 of 1	REV G
CUSTOMER DRAWING						

