

COMPONENTS / ACCESSORIES

HORIZONTAL RAILS



Rear horizontal rail, centre (D1)



When using 6 U PCBs or box-type plug-in units. Facility for the attachment of Z rails, insulating strips or conductive strips.

- 84 tapped holes M2.5
- M4 thread on end face
- Straight-through core hole
- Horizontal rail 192 HP for cutting to the required length

Material:
Extruded aluminum section

Surface finish:
Clear-chromated or anodized

Usable width (HP)	Packs of	Order No.
40	1	3684.963
42	1	3684.580
63	1	3684.581
84	1	3684.582
84	1	3685.270¹⁾
858.5 mm	1	3684.579
192	1	3688.003²⁾

¹⁾ Including 2 assembly screws
²⁾ Anodized

! Also required:

Assembly screws M4 x 12, packs of 100, order no. 3654.300, see page 164

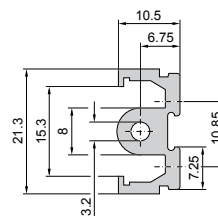
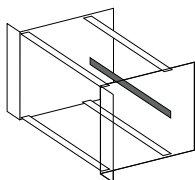

Rear horizontal rail, centre, with integral Z rail (D2)



When using 6 U PCBs or box-type plug-in units. Integral Z rail for mounting connectors to IEC 60 603-2.

- 84 tapped holes M2.5
- M4 thread on end face
- Straight-through core hole

Material:
Extruded aluminum section

Surface finish:
Clear-chromated

Usable width (HP)	Packs of	Order No.
42	1	3687.600
63	1	3687.601
84	1	3687.602
858.5 mm	1	3687.603

! Also required:

Assembly screws M4 x 12, packs of 100, order no. 3654.300, see page 164

