

LOC	DIST	REVISIONS		
—	—	P	LTR	DESCRIPTION
				DATE
				DWN
				APVD
		D		INTERNAL COMPONENT PART NUMBER CHANGE
				16NOV2015
				KJK
				PS

POS. PER ROW	L +0.4 -0.7	PART NUMBER	
—	—	—	—
2	5.08	—	-2
3	7.62	—	-3
4	10.16	—	-4
5	12.70	829759-5	
6	15.24	—	-6
7	17.78	—	-7
8	20.32	—	-8
9	22.86	—	-9
10	25.40	1-829759-0	
11	27.94	1-	-1
12	30.48	1-	-2
13	33.02	1-	-3
14	35.56	1-	-4
15	38.10	1-	-5 $\triangle 2$
16	40.64	1-	-6
17	43.18	1-	-7
18	45.72	1-	-8
19	48.26	1-	-9
20	50.80	2-	-0 $\triangle 2$
21	53.34	2-	-1
22	55.88	2-	-2
23	58.42	2-	-3
24	60.96	2-	-4
25	63.50	2-	-5
26	66.04	2-	-6
27	68.58	2-	-7
28	71.12	2-	-8
29	73.66	2-	-9
30	76.20	3-829759-0	$\triangle 2$
31	78.74	3-	-1
32	81.28	3-	-2 $\triangle 2$
33	83.82	3-	-3
34	86.36	3-	-4
35	88.90	3-	-5
36	91.44	3-	-6 $\triangle 2$
37	93.98	3-	-7
38	96.52	3-	-8
39	99.06	3-	-9
40	101.60	4-	-0
41	104.14	4-	-1
42	106.68	4-	-2
43	109.22	4-	-3
44	111.76	4-	-4
45	114.30	4-	-5
46	116.84	4-	-6
47	119.38	4-	-7
48	121.92	4-	-8
49	124.46	4-	-9
50	127.00	5-829759-0	$\triangle 2$

NOTES:

- $\triangle 1$ MIN 2.0 μ m TIN OVER 1.27 μ m NICKEL
- $\triangle 2$ OBSOLETE PARTS: OBSOLETE CIS STREAMLINING PER D.RENAUD/D.SINISI

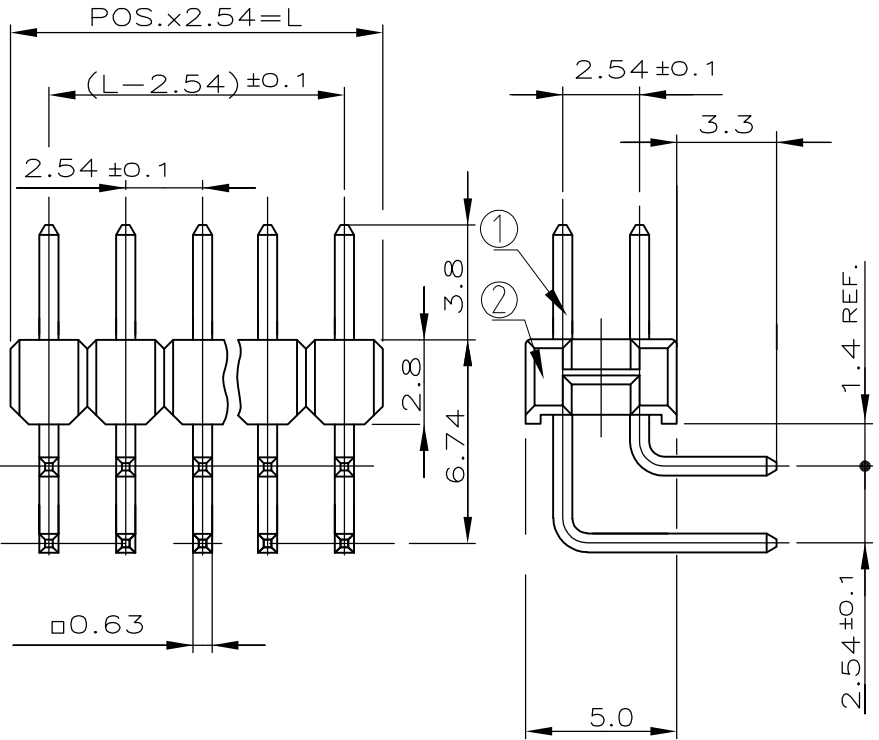

1	CONTACT PIN	CuSn	$\triangle 1$
2	PIN HOUSING	PBT	GREEN
ITEM NUM	DESCRIPTION	MATERIAL	COLOR/FINISH

RELEASED FOR PUBLICATION

ALL RIGHTS RESERVED.

By -

COPYRIGHT

THIS DRAWING IS UNPUBLISHED.

DIMENSIONS:

mm

TOLERANCES UNLESS OTHERWISE SPECIFIED:
 ± 0.2 mm

0 PLC	± -
1 PLC	± -
2 PLC	± -
3 PLC	± -
4 PLC	± -
ANGLES	± -

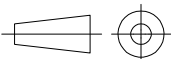

DWN A.HO	14.05.91	MATERIAL SEE TABLE	FINISH —
CHK M.SCHAARSCHMIDT	14.05.91		
APVD —	—		
PRODUCT SPEC —	—	NAME AMPMODU II PIN HEADER 90 DEG, DUAL ROW	
APPLICATION SPEC —	—	SIZE A4	CAGE CODE 00779
WEIGHT —	—	DRAWING NO C-829759	RESTRICTED TO —
CUSTOMER DRAWING		SCALE 4:1	SHEET 1 OF 1
			REV D