

REVISIONS					
REV.	DATE	DESCRIPTION	BY	CHK	APPV
P8	25OCT2016	REVISED	ECR-16-003344	KF	HY

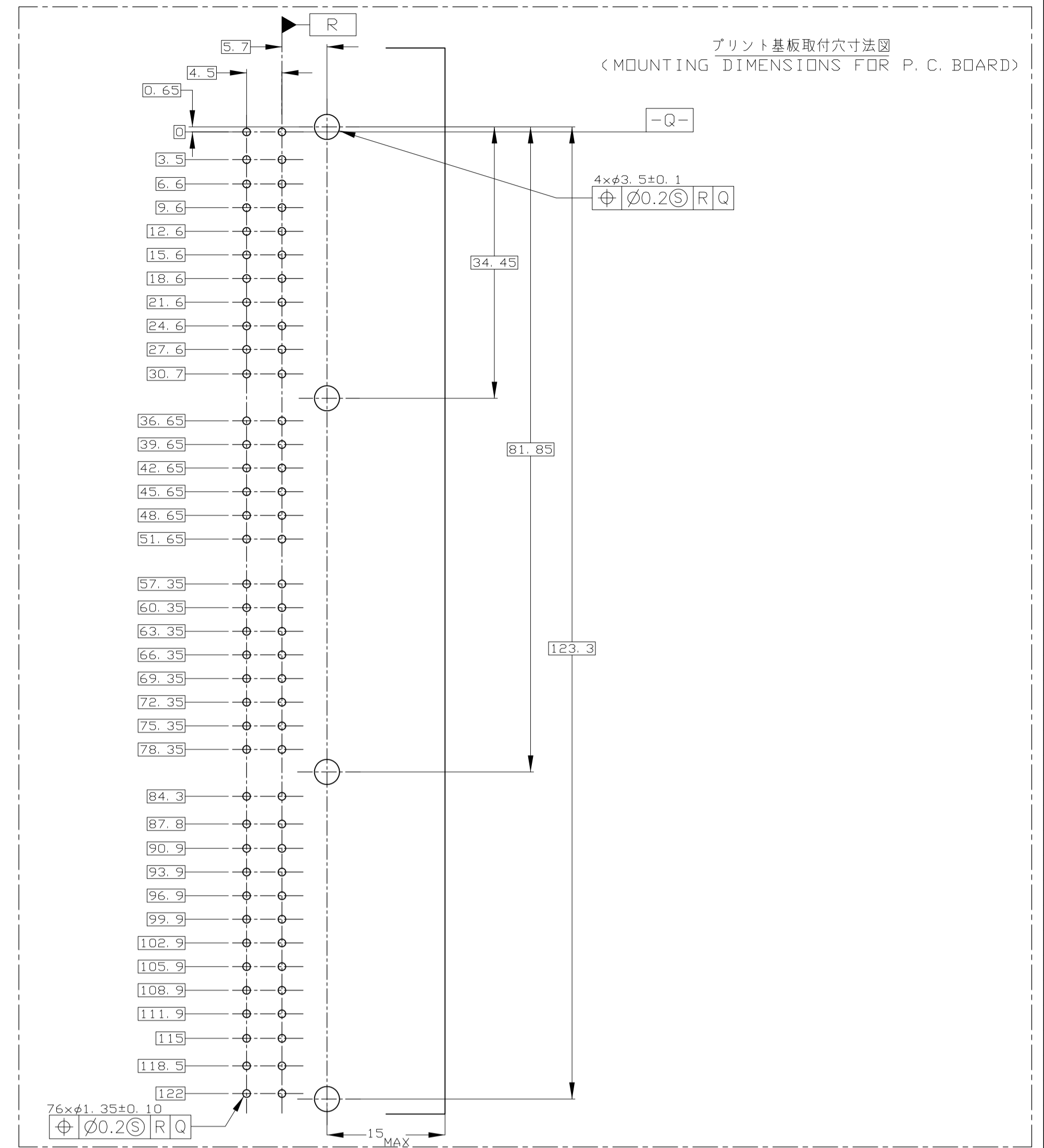

- △ X 面から2mmの範囲で測定
- 2. 嵌合相手ハウジング型: 174516, 174515, 174514, 174913
917992, 917989, 917981, 917975
- 3. 推奨取付ねじ: JIS B1115, B1122 タップねじ, なべ2種
呼び径3, 長さ6mm以下 (締付けトルク: 0.4N-cm以下)
- 4. 適用製品規格番号: 108-5280, 108-5342
- △ 回路番号: 右図参照のこと
- パワ回路 ① ~ ⑩
- シグナル回路 ⑪ ~ ⑯
- △ 適用製品規格のグラフィックス及びIDマークを
カマネットマークにて表示

- △ MUST BE KEPT BETWEEN X AND 2
- 2 THE MATING PLUG HSG. PART NUMBER; 174516, 174515, 174514, 174913
917992, 917989, 917981, 917975
- 3 RECOMMENDED MOUNTING SCREW; 3mmDIA, 6mmLENGTH MAX.)
PAN HEAD, CLASS 2 TAPPING SCREW SPECIFIED IN JIS
B1115, B1122
(TIGHTENING TORQUE; 0.4N-cm MAX.)
- 4 APPLICABLE PRODUCT SPEC NO. 108-5280, 108-5342
- △ CIRCUIT NUMBER
- POWER CIRCUIT NO. ① ~ ⑩
- SIGNAL CIRCUIT NO. ⑪ ~ ⑯
- △ INDICATED PREFIX AND ID MARK OF PRODUCT P/N BY HOT MARK

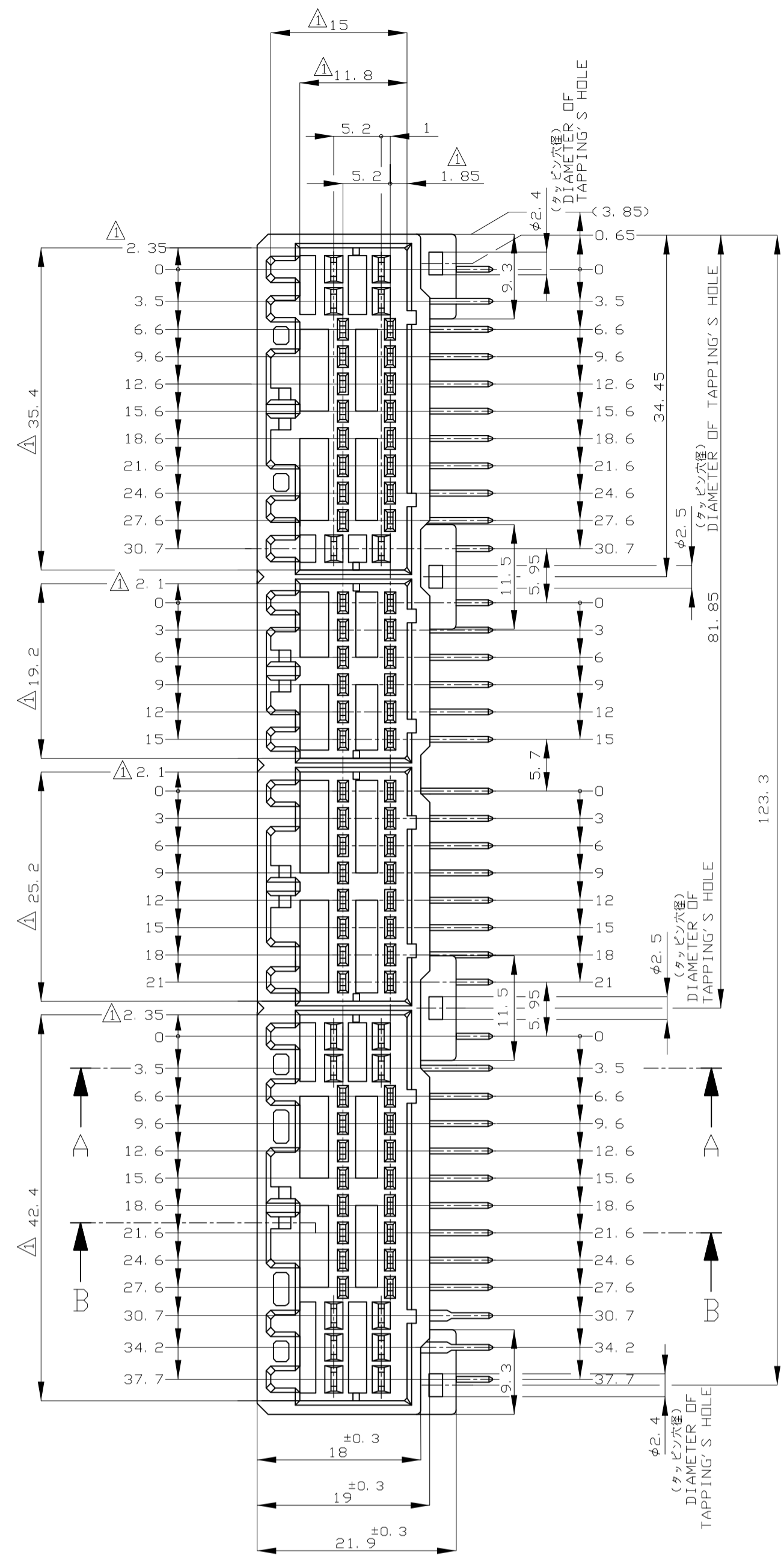
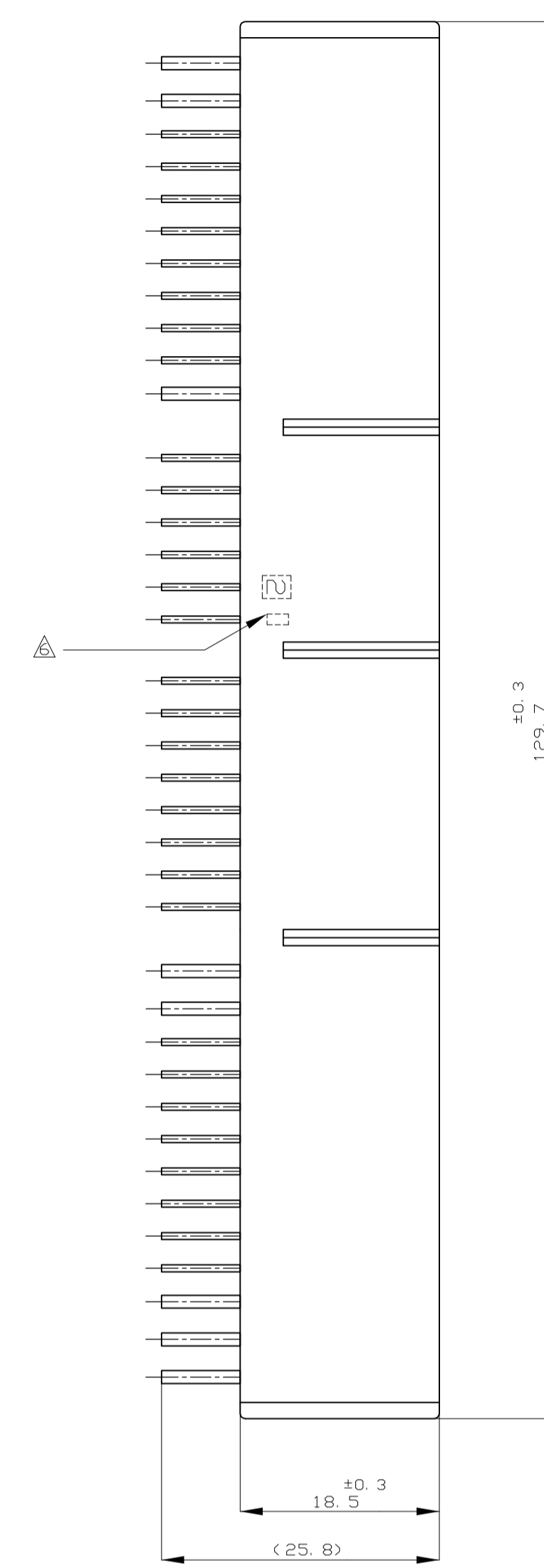
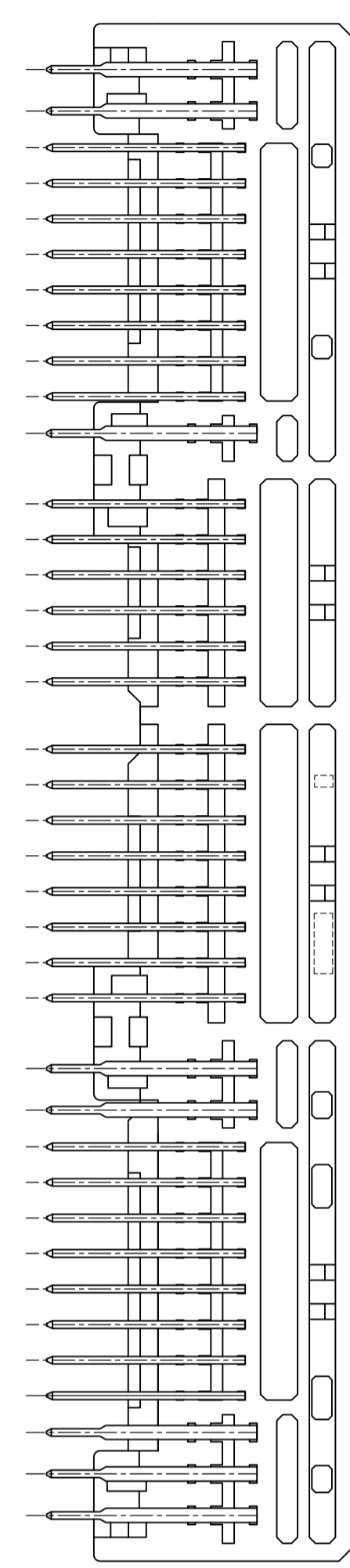
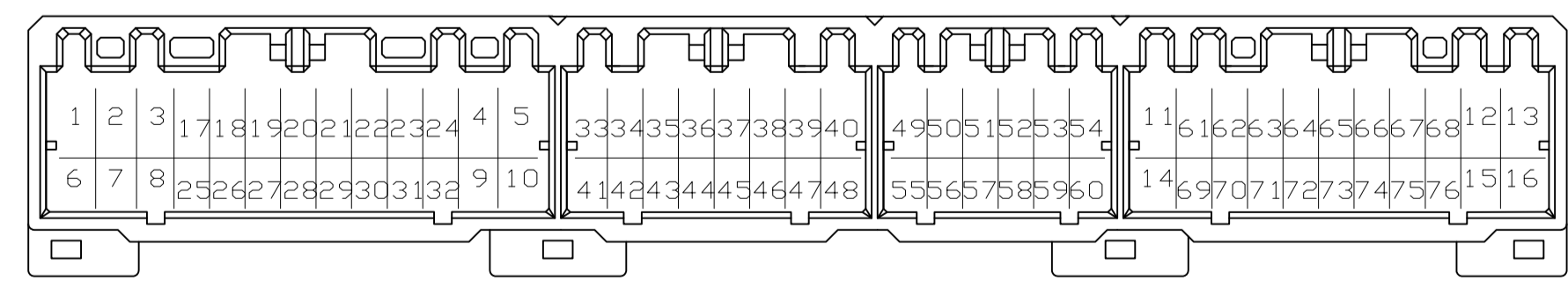
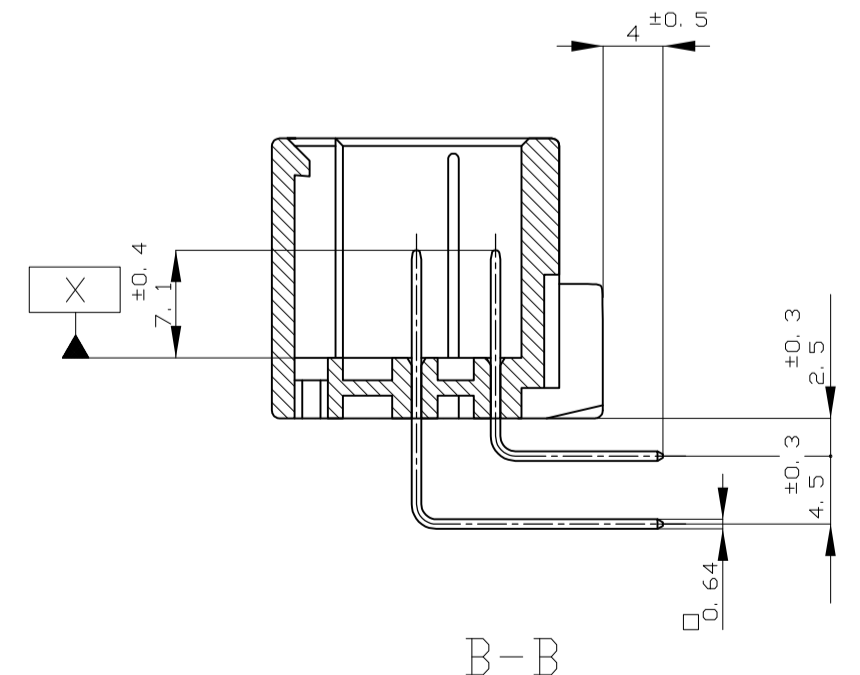
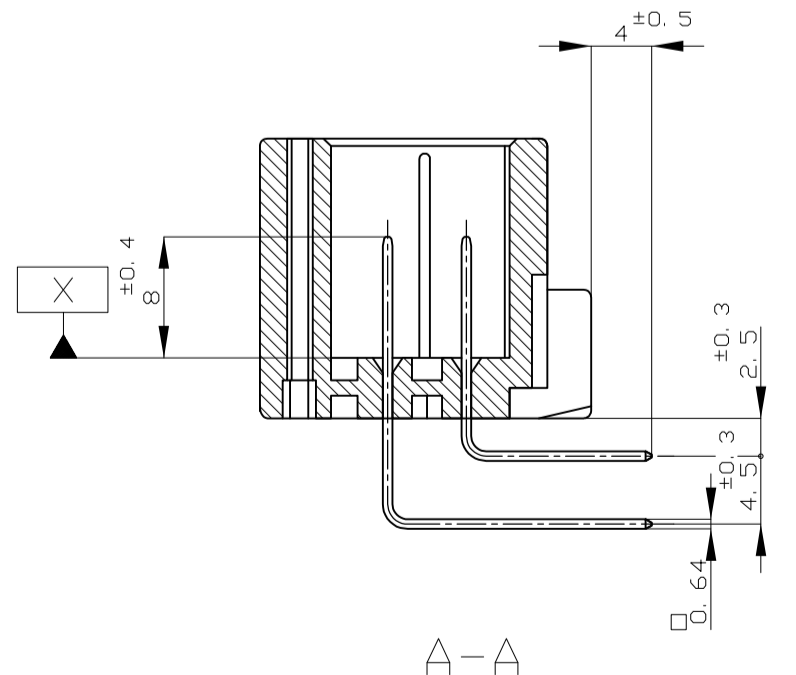

NO.	SELECTIVE-TIN (MATT)	SELECTIVE GOLD	PRE-TIN	SIZE	COLOR	PART NUMBER
56	SELECTIVE-TIN (MATT)	SELECTIVE GOLD x 14	PRE-TIN x 62	24, 31, 39, 40, 42~50, 55	GRAY	6-5178780-6
55	SELECTIVE-TIN (MATT)	SELECTIVE GOLD x 28	PRE-TIN x 48	25~32, 35~40, 43~52, 55~58	BLACK	5-5178780-2
55	SELECTIVE-TIN (MATT)	SELECTIVE GOLD x 28	PRE-TIN x 48	25~32, 35~40, 43~52, 55~58	NATURAL	5-5178780-1
54	SELECTIVE-TIN (MATT)	SELECTIVE GOLD x 28	PRE-TIN x 48	23, 24, 31~51, 55~57, 63, 64	YELLOW	4-5178780-7
54	SELECTIVE-TIN (MATT)	SELECTIVE GOLD x 8	PRE-TIN x 68	49, 50, 52, 53, 68, 70, 71, 74	GRAY	4-5178780-6
53	SELECTIVE-TIN (MATT)	SELECTIVE GOLD x 12	PRE-TIN x 64	26~32, 40, 49~52	YELLOW	3-5178780-7
53	SELECTIVE-TIN (MATT)	SELECTIVE GOLD x 60	PRE-TIN x 16	17~76	GRAY	3-5178780-6
52	SELECTIVE-TIN (MATT)	SELECTIVE GOLD x 24	PRE-TIN x 52	23, 24, 31, 33~49, 55, 63, 64	YELLOW	2-5178780-7
52	SELECTIVE-TIN (MATT)	SELECTIVE GOLD x 19	PRE-TIN x 57	22, 24, 31, 34, 39~40, 42~48, 49, 50, 55, 56, 63, 64	GRAY	2-5178780-6
△ 8	TIN-LEAD	SELECTIVE GOLD x 7	PRE-TIN x 69	49, 50, 52, 53, 68, 70, 74	GRAY	8-178780-6
△ 7	TIN-LEAD	SELECTIVE GOLD x 10	PRE-TIN x 66	24, 31, 39, 44~47, 49, 55, 64	GRAY	7-178780-6
△ 6	TIN-LEAD	SELECTIVE GOLD x 14	PRE-TIN x 62	24, 31, 39, 40, 42~50, 55	GRAY	6-178780-6
△ 5	TIN-LEAD	SELECTIVE GOLD x 28	PRE-TIN x 48	25~32, 35~40, 43~52, 55~58	YELLOW	5-178780-7
△ 5	TIN-LEAD	SELECTIVE GOLD x 28	PRE-TIN x 48	25~32, 35~40, 43~52, 55~58	BLACK	5-178780-2
△ 5	TIN-LEAD	SELECTIVE GOLD x 28	PRE-TIN x 48	25~32, 35~40, 43~52, 55~58	NATURAL	5-178780-1
△ 4	TIN-LEAD	SELECTIVE GOLD x 28	PRE-TIN x 48	23, 24, 31~51, 55~57, 63, 64	YELLOW	4-178780-7
△ 4	TIN-LEAD	SELECTIVE GOLD x 8	PRE-TIN x 68	49, 50, 52, 53, 68, 70, 71, 74	GRAY	4-178780-6
△ 3	TIN-LEAD	SELECTIVE GOLD x 60	PRE-TIN x 16	17~76	GRAY	3-178780-6
△ 2	TIN-LEAD	SELECTIVE GOLD x 24	PRE-TIN x 52	23, 24, 31, 33~49, 55, 63, 64	YELLOW	2-178780-7
△ 0	TIN-LEAD	SELECTIVE GOLD x 76	PRE-TIN x 76	-	LIGHT GRAY	178780-9
△ 1	SELECTIVE-TIN (MATT)	SELECTIVE-TIN (BRIGHT) x 76	PRE-TIN x 76	-	NATURAL	178780-3
△ 0	SELECTIVE-TIN (MATT)	SELECTIVE-TIN (BRIGHT) x 76	PRE-TIN x 76	-	NATURAL	178780-1

THIS DRAWING IS A CONTROLLED DOCUMENT.

DIMENSIONS: mm

TOLERANCES UNLESS OTHERWISE SPECIFIED

GENERAL TOLERANCE

MATERIAL: HOUSING: PBT CONTACT: BRASS

FINISH: 仕上

SEE TABLE

WEIGHT: 23.8 g

SCALE: 2:1

SHEET: 1 of 1

REV: P8

STE TE Connectivity

76POS CAP HOUSING ASSY
 .040/.070 SERIES HYBRID I/O CONN. (NON FLANGE)

00779 178780