

REVISION RECORD				
REV	ECO	DESCRIPTION	DRFT	CHKD

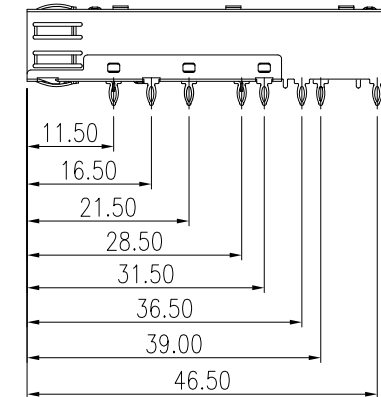
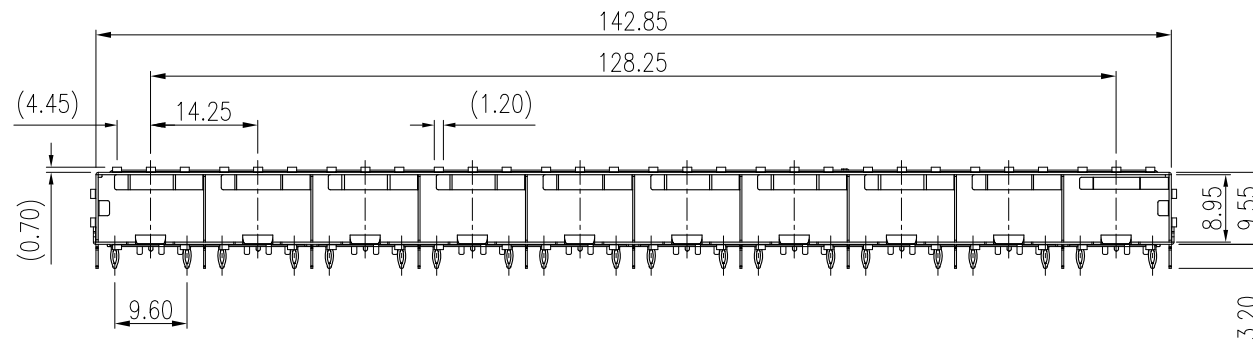
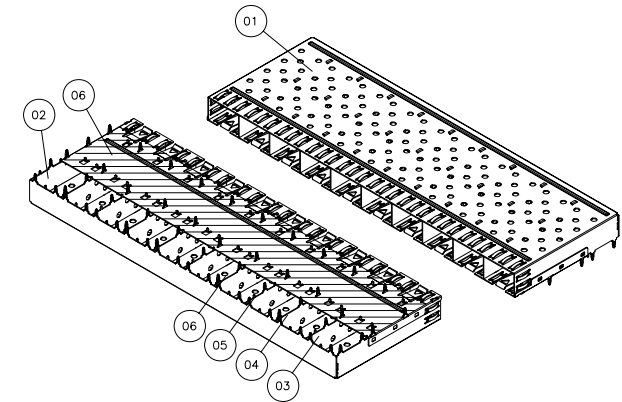
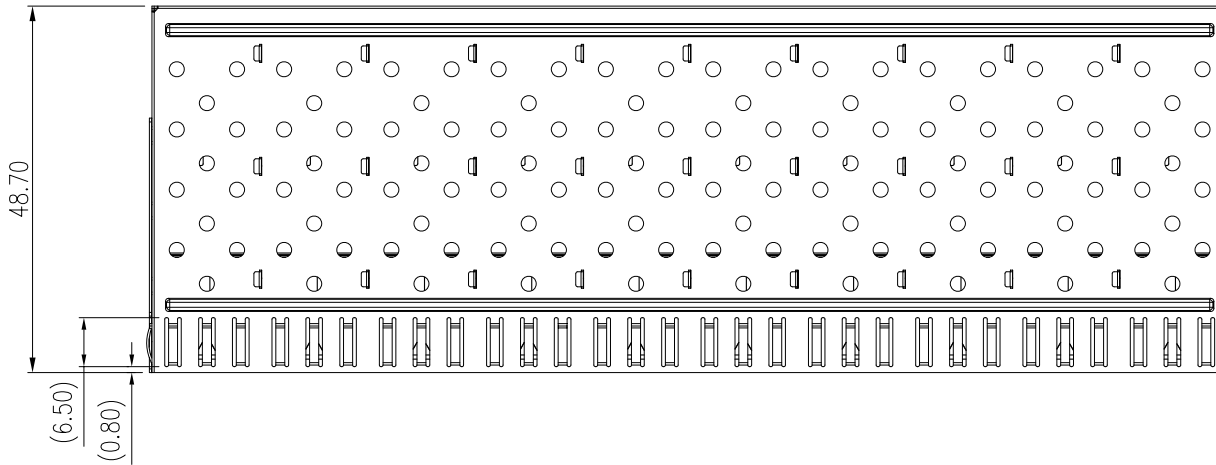

Qty per:		Tray	Carton
PART NUMBER : SFPCAGE006-L			
No.	DESCRIPTION	Q'ty	MATERIAL
01	CAGE TOP	1	COPPER ALLOY
02	CAGE BOTTOM	1	COPPER ALLOY
03	CAGE MIDDLE-1	3	COPPER ALLOY
04	CAGE MIDDLE-2	2	COPPER ALLOY
05	CAGE MIDDLE-3	1	COPPER ALLOY
06	CAGE MIDDLE-4	3	COPPER ALLOY
07	ISOLATION	1	

NOTE:
 MECHANICAL:
 SHIELD(CAGE) MATERIAL:
 1. THICKNESS=0.25mm, 0.30mm
 2. PLATED NICKEL 50u~80u

MM (INCH)	
TOLERANCES EXCEPT AS NOTED	
MM	±
.0 ± 0.2	±
.00 ± 0.15	±
.000 ± 0.075	±
ANGLES ± 0.5	
THIRD ANGLE PROJECTION	

RoHS Compliant



TITLE
 SFP CAGE 1B10

DFTO	Laura Su	DRAWING NO.	SFPCAGE006-L	SIZE	REV
DATE	02/06/2007	/PART NO.	SFPCAGE006-L	A3	R3
SCALE : N/A		DO NOT SCALE DRAWING		SHEET 1 OF 3	

REVISION RECORD				
REV	ECO	DESCRIPTION	DRFT	CHKD

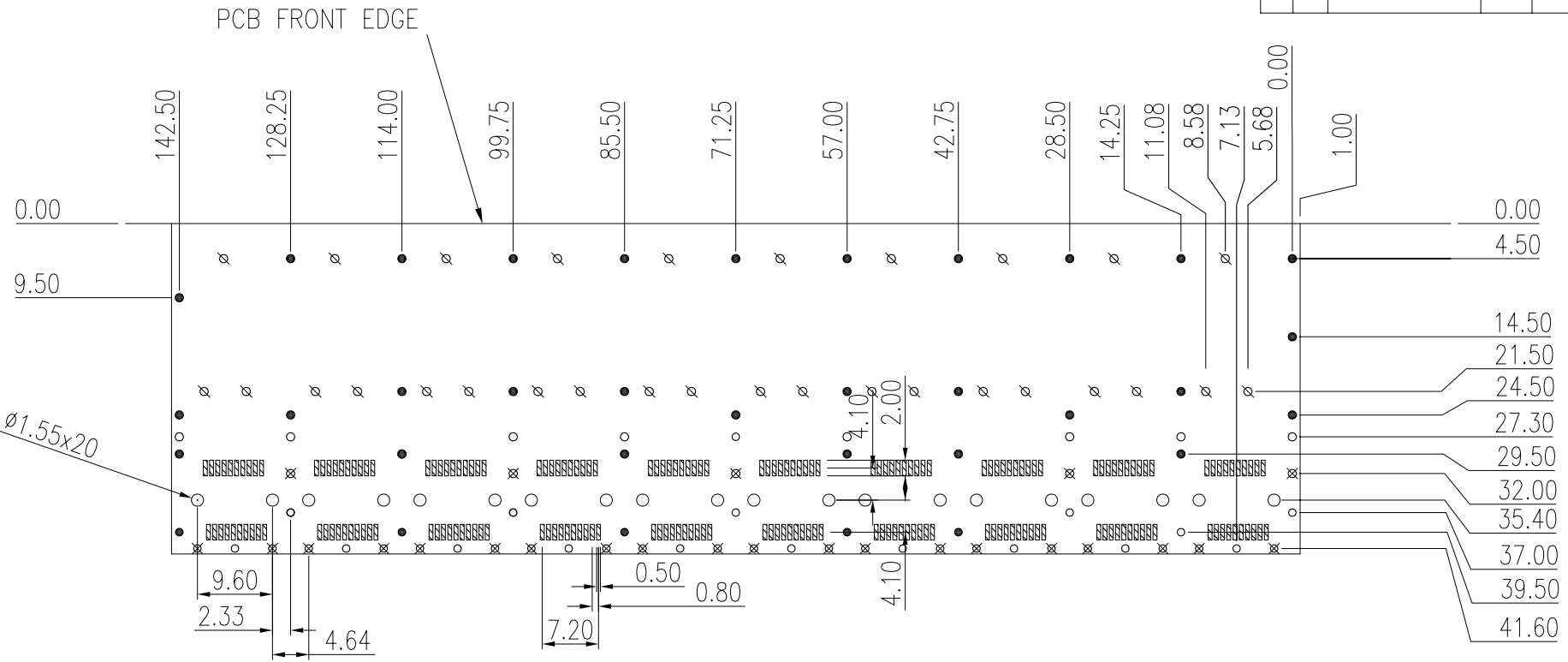

Ø1.55x20

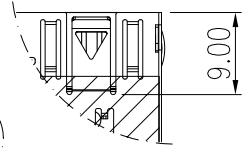
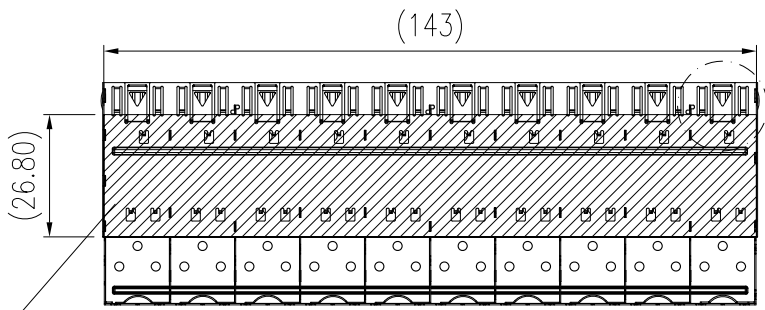

	QUANTITY	DIA.	INSERTION
Ø	30	Ø1.05	
●	35	Ø1.05	WIDE PRESS FIT
⊗	25	Ø0.95	NARROW PRESS FIT
○	25	Ø0.95	

ISOLATION (PASTE ON SFP CAGE BOTTOM)
 MATERIAL: MYLAR PAPER or "KAPTON", T= 0.05~0.1mm MAX.
 INSULATION RESISTANCE: AROUND 100V.
 TEMPERATURE REQUIREMENT: NO HIGH-TEMPERATURE.

DETACHED LISTS	MM (INCH)	RoHS Compliant			
	TOLERANCES EXCEPT AS NOTED	TITLE			
	MM	SFP CAGE 1B10			
	ANGLES ± 0.5	DFTO Laura Su DRAWING NO. SFPCAGE006-L SIZE A3 REV R3			
THIRD ANGLE PROJECTION	DATE 02/06/2007	/PART NO. SFPCAGE006-L		DO NOT SCALE DRAWING SHEET 2 OF 3	
SCALE : N/A		DO NOT SCALE DRAWING		SHEET 2 OF 3	

REVISION RECORD				
REV	ECO	DESCRIPTION	DRFT	CHKD

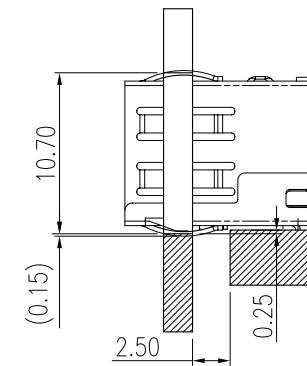
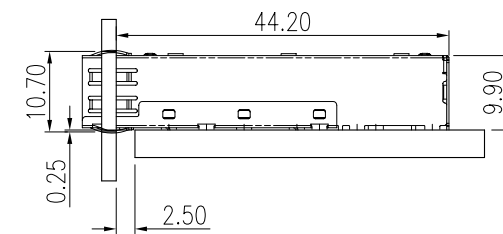
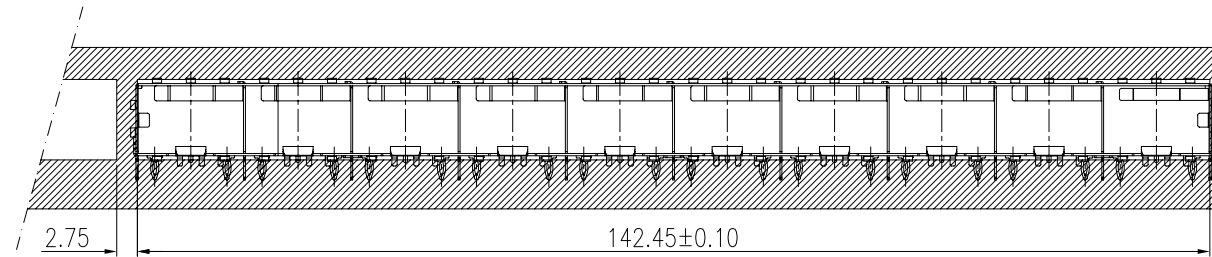

SFP CAGE 1BY10

DETACHED LISTS	← MM (INCH) →	RoHS Compliant					
	TOLERANCES EXCEPT AS NOTED						
	MM		TITLE				
	.0 ± 0.2	±	SFP CAGE 1BY10				
.00 ± 0.15	±	DFTO	Laura Su	DRAWING NO.	SFPCAGE006-L	SIZE	REV
.000 ± 0.075	±	DATE	02/06/2007	/PART NO.	SFPCAGE006-L	A3	R3
ANGLES ± 0.5		SCALE :	N/A	DO NOT SCALE DRAWING		SHEET	3 OF 3
THIRD ANGLE PROJECTION							

8 7 6 5 4 3 2 1

H
G
F
E
D
C
B
A