

Aug.1.2018 Copyright 2018 HIROSE ELECTRIC CO., LTD. All Rights Reserved.
 In case that the application demands a high level of reliability, such as automotive,
 please contact a company representative for further information.

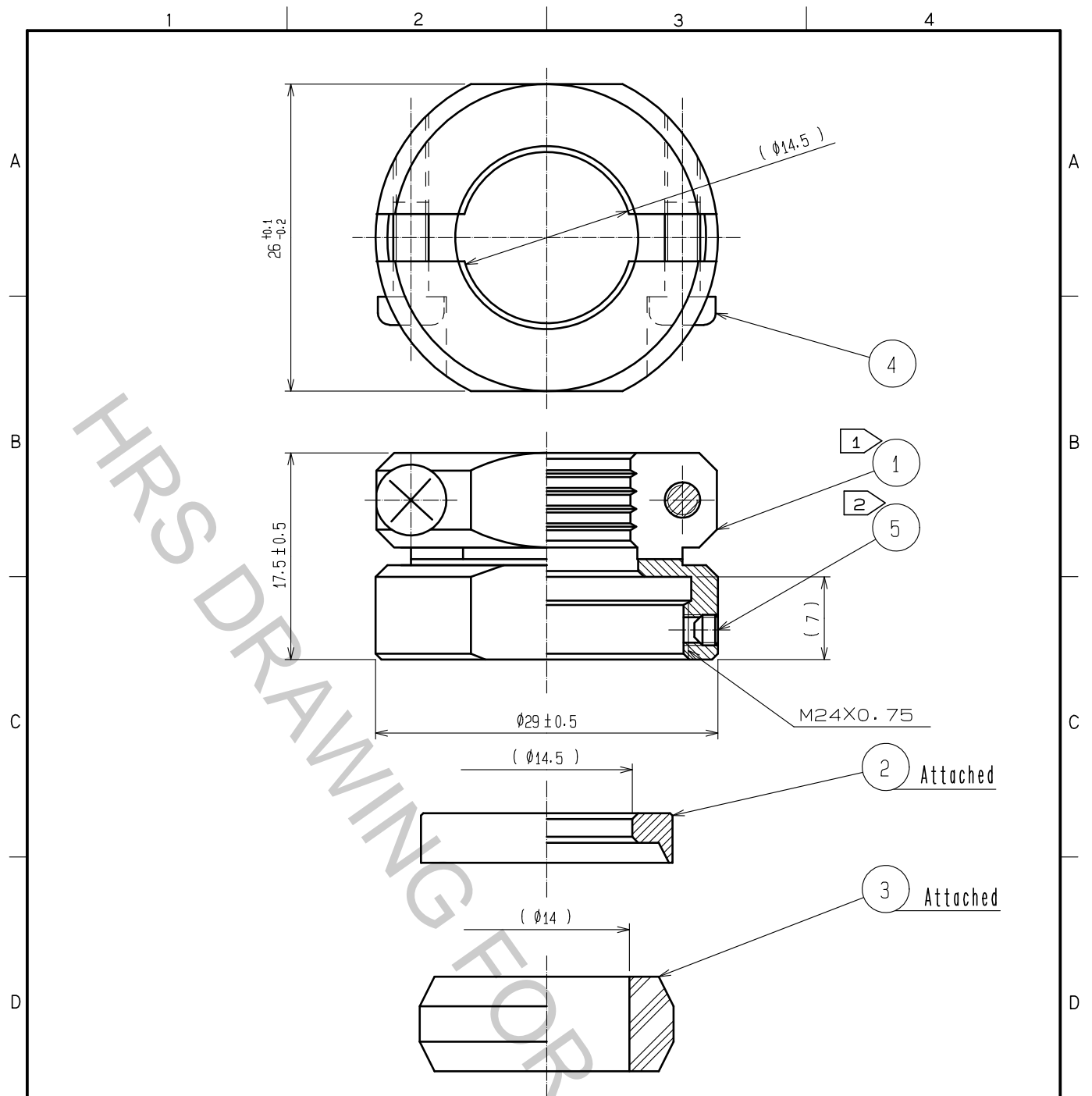

- Notes
- ① The recommended tightening torque of ref.No. ① shall be 2 to 3N · m. LOCTITE 263, HENKEL JAPAN or equevalent is recommended to prevent ref. No. ① from loosening.
 - ② Across flats of hexagon hole of ref. No. ⑤ to be 1.27. The recommended tightening torque of ref.No. ⑤ shall be 0.3 to 0.4N · m.
 - ③ The cable pull and twisting strength (, waterproof tightness) and other characteristics may differ, depending on the cable structure, please confirm before the use.

3	Synthetic rubber	(Black)					
2	Brass	Nickel plating	5	Stainless steel	JIS B 1177 Hexagon socket set screw M2.6×0.45×2		
1	Brass	Nickel plating	4	Brass	Nickel plating JIS B 1111 Pan head machine screw M3×0.5×8		
NO.	MATERIAL	FINISH	REMARKS	NO.	MATERIAL	FINISH	REMARKS

UNITS mm		SCALE 2 : 1	COUNT 	DESCRIPTION OF REVISIONS	DESIGNED	CHECKED	DATE
HIROSE ELECTRIC CO., LTD.		APPROVED ·HY. KOBAYASHI	18.02.22	DRAWING NO.	EDC-112372-31-00		
		CHECKED ·HY. KOBAYASHI	18.02.22	PART NO.	RM24WTP-CP14(31)		
		DESIGNED ·HY. KISHI	18.02.22	CODE NO.	CL109-1851-9-31		
		DRAWN ·MK. INOUE	18.02.08		1/1		