

Tous droits strictement reserves. Reproduction ou communication a des tiers interdite sous quelque forme que ce soit sans autorisation écrite du propriétaire. Propriete de c FCI. Droits de reproduction FCI.

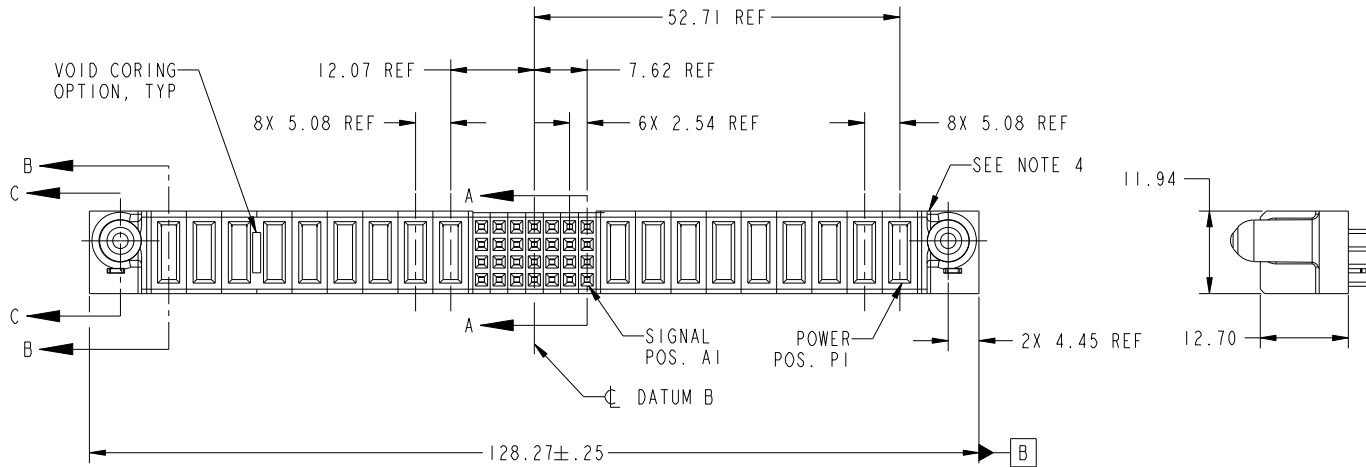

All rights strictly reserved. Reproduction or issue to third parties in any form whatever is not permitted without written authority from the proprietor. Property of FCI. Copyright FCI.

| | | | | | | | | | | | | | | | | | | | | | | | | | | | | | |
|------------------------|------------------|-------|-----|-----|-----|-----|-----|-----|-----|-----|-----|--------|---|---|---|---|-------|---|----|----|----|----|----|----|----|----|----|----|--|
| PRODUCT NO. | ROWS | POWER | | | | | | | | | | SIGNAL | | | | | POWER | | | | | | | | | E1 | | | |
| | | E2 | P18 | P17 | P16 | P15 | P14 | P13 | P12 | P11 | P10 | 7 | 6 | 5 | 4 | 3 | 2 | 1 | P9 | P8 | P7 | P6 | P5 | P4 | P3 | | P2 | P1 | |
| 51750-081-- NOTE: 3 | D C B A | | | | | | | | | | | | | | | | | | | | | | | | | | | | |



| CODE | DIM "M" MATING LENGTH | CONTACT TYPE |
|------|-----------------------|--------------|
| E | [N/A] | SIGNAL |
| PA | [1.07] | POWER |
| HA | [N/A] | HOLD-DOWN |
| X | [N/A] | OMITTED |

| | | | | | | | | | | | |
|-------------|----------------|----|----------|-----------|----------------------|---------------------------------------|----------------|----------|------------------------|------------------------|--------|
| mat'l code | | | | SEE NOTES | | tolerances unless otherwise specified | | CUSTOMER | | www.fciconnect.com | |
| ltr | ecn no. | dr | date | linear | 0.X ± 0.3 | projection | COPY | | title | | |
| A | DG07-0408 | JC | 09/28/07 | angles | 0.XX ± 0.13 | | 9P + 28S + 9P | | VERTICAL SOLDER RECEPT | | |
| | | | | | 0.XXX ± 0.051 | | product family | | PwrBlade | code | |
| | | | | dr | 0° ± 2° | scale | size | | A | dwg no | 213 |
| | | | | enr | Jerome Chen 09/28/07 | 1:1 | product family | | 51750-081 | | sheet |
| | | | | chr | Jerome Chen 09/28/07 | | size | | A | | 1 of 4 |
| | | | | appd | Gary Hsieh 09/28/07 | | cage code | | 22526 | | |
| | | | | | Joseph Hsia 09/28/07 | | cage code | | 22526 | | |
| sheet index | revision sheet | A | A | A | A | | cage code | | 22526 | | |
| | | 1 | 2 | 3 | 4 | | cage code | | 22526 | | |

Pro/E

cage code 22526

Tous droits strictement reserves. Reproduction ou communication a des tiers interdite sous quelque forme que ce soit sans autorisation écrite du propriétaire. Propriete de c FCI. Droits de reproduction FCI.

All rights strictly reserved. Reproduction or issue to third parties in any form whatever is not permitted without written authority from the proprietor. Property of FCI. Copyright FCI.



PRODUCT NUMBER
51750-081--
NOTE: 3

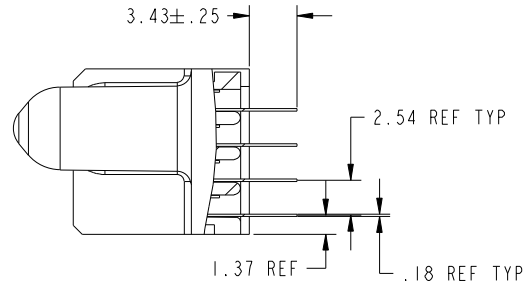

SECTION A-A
SCALE 2:1

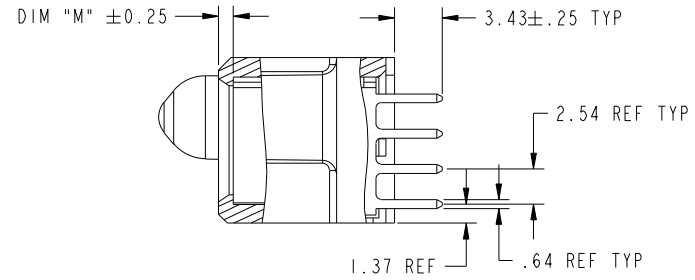

SECTION B-B
SCALE 2:1

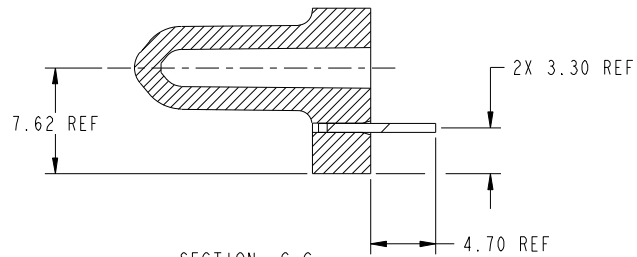

SECTION C-C
SCALE 2:1

| | | | | | | | | | |
|-------------|---------|----------------|------|---------------------------------------|----------------------|------------|--|---|--|
| mat'l code | | | | tolerances unless otherwise specified | | CUSTOMER | | FCI | |
| ltr | ecn no. | dr | date | linear | 0.X ± 0.3 | COPY | | www.fciconnect.com | |
| A | | | | | 0.XX ± 0.13 | projection | | title | |
| | | | | angles | 0.XXX ± 0.051 | | | 9P + 28S + 9P VERTICAL SOLDER RECEPT | |
| | | | | dr | Jerome Chen 09/28/07 | MIM | | product family PwrBlade code | |
| | | | | enr | Jerome Chen 09/28/07 | | | size 213 | |
| | | | | chr | Gary Hsieh 09/28/07 | scale | | dwg no 51750-081 sheet | |
| | | | | appd | Joseph Hsia 09/28/07 | 1:1 | | 2 of 4 | |
| sheet index | | revision sheet | | | | | | | |

cage code 22526

Pro/E

Tous droits strictement reserves. Reproduction ou communication a des tiers interdite sous quelque forme que ce soit sans autorisation écrite du propriétaire. Propriete de c FCI. Droits de reproduction FCI.



All rights strictly reserved. Reproduction or issue to third parties in any form whatever is not permitted without written authority from the proprietor. Property of FCI. Copyright FCI.

PRODUCT NUMBER
51750-081--
NOTE: 3

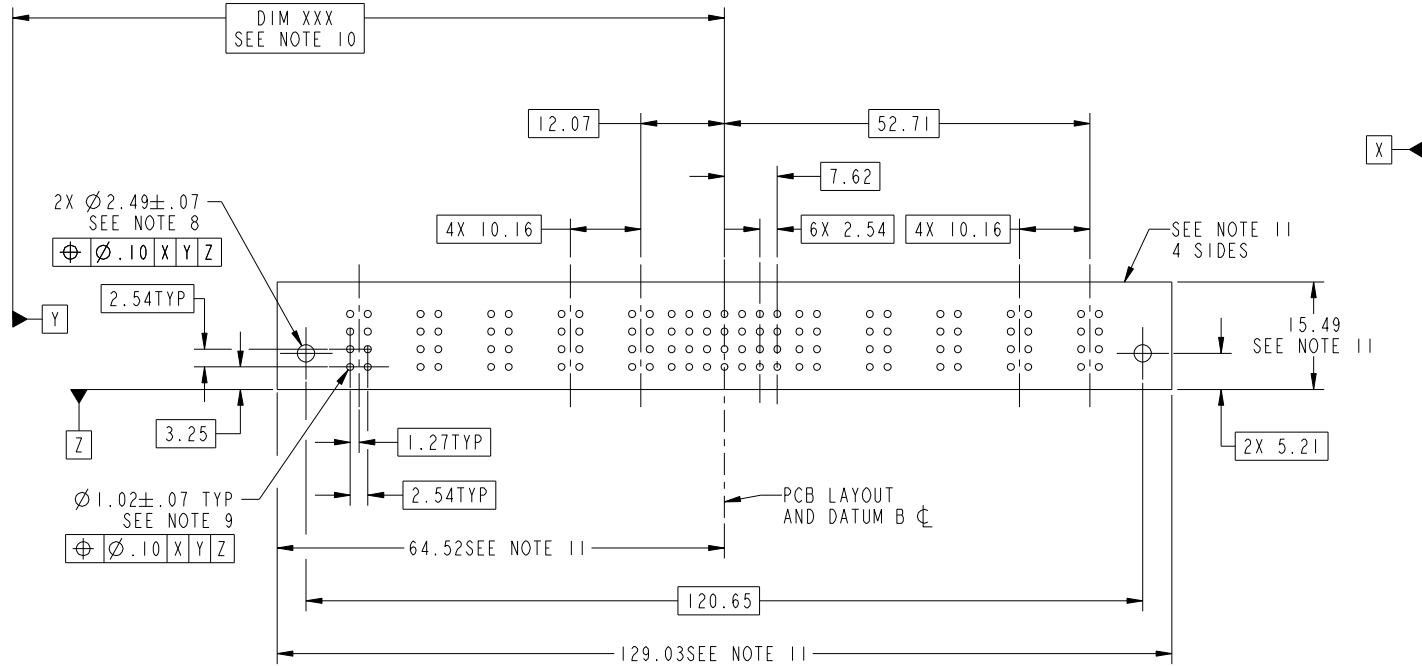

RECOMMENDED PCB LAYOUT

| | | | | | | | | | |
|-------------|---------|----------------|------|---------------------------------------|----------------------|------------|--|---|--|
| mat'l code | | | | tolerances unless otherwise specified | | CUSTOMER | | FCI | |
| ltr | ecn no. | dr | date | linear | 0.X ± 0.3 | COPY | | www.fciconnect.com | |
| A | | | | | 0.XX ± 0.13 | projection | | title | |
| | | | | angles | 0.XXX ± 0.051 | | | 9P + 28S + 9P VERTICAL SOLDER RECEPT | |
| | | | | dr | Jerome Chen 09/28/07 | MIM | | product family PwrBlade code | |
| | | | | enr | Jerome Chen 09/28/07 | | | size 213 | |
| | | | | chr | Gary Hsieh 09/28/07 | scale | | dwg no 51750-081 sheet | |
| | | | | appd | Joseph Hsia 09/28/07 | 1:1 | | 3 of 4 | |
| sheet index | | revision sheet | | | | | | | |

cage code 22526

Pro/E

Tous droits strictement reserves. Reproduction ou communication a des tiers interdite sous quelque forme que ce soit sans autorisation écrite du propriétaire. Propriete de c FCI. Droits de reproduction FCI.



All rights strictly reserved. Reproduction or issue to third parties in any form whatever is not permitted without written authority from the proprietor. Property of FCI. Copyright FCI.

PRODUCT NUMBER
51750-081--
NOTE: 3

NOTES:

1. DIMENSIONS AND TOLERANCES ARE IN ACCORDANCE WITH ASME Y14.5M, 1994 UNLESS OTHERWISE SPECIFIED.

CONNECTOR NOTES:

- 2 HOUSING MATERIAL: UL 94 V-0 GLASS FILLED HIGH-TEMP THERMOPLASTIC
POWER CONTACT MATERIAL: COPPER ALLOY
SIGNAL PIN MATERIAL: COPPER ALLOY
 - 3. PLATING SPEC.
51750-081, 51750-081LF PLATING SPEC. WAS SHOWN IN THE PRINT OF 10064183.
 - 4 MANUFACTURER'S NAME, P/N, AND DATE CODE TO APPEAR ON THIS SURFACE.
 - 5. PRODUCT SPECIFICATION GS-12-149.
APPLICATION SPECIFICATION BUS-20-067.
 - 6. PACKAGED IN TRAYS.
- PCB NOTES:
- 7. ALL HOLE DIAMETERS ARE FINISHED HOLE SIZE.

- 8 MOUNTING HOLES, WHERE APPLICABLE, ARE UNPLATED.
- 9 $\varnothing 1.151 \pm 0.025$ DRILLED HOLES PLATED WITH
0.008 MIN SnPb OR Sn OVER 0.03
TO 0.08 Cu PLATING TO ACHIEVE
 $\varnothing 1.02 \pm .07$ HOLE.
- 10 "DIM XXX" TO BE DETERMINED BY THE CUSTOMER.
- 11 CONNECTOR KEEP-OUT ZONE.

| | | | | | | | | | |
|-------------|----------------|----|------|---------------------------------------|----------------------|------------------------|--|--------------------|-------|
| mat'l code | | | | tolerances unless otherwise specified | | CUSTOMER | | FCI | |
| ltr | ecn no. | dr | date | linear | 0.X ± 0.3 | COPY | | www.fciconnect.com | |
| A | | | | projection | 0.XX ± 0.13 | title | | 9P + 28S + 9P | |
| | | | | angles | 0.XXX ± 0.051 | VERTICAL SOLDER RECEPT | | | |
| | | | | dr | 0° ± 2° | product family | | PwrBlade | code |
| | | | | enrg | Jerome Chen 09/28/07 | size | | dwg no | 213 |
| | | | | chr | Jerome Chen 09/28/07 | scale | | 51750-081 | sheet |
| | | | | appd | Gary Hsieh 09/28/07 | 1:1 | | 4 of 4 | |
| | | | | | Joseph Hsia 09/28/07 | A | | | |
| sheet index | revision sheet | | | | | | | | |

cage code 22526

Pro/E