

PART NUMBER	REV	FIRST USED
687390-1	V	122500-1
687390-2	A	
687390-3	A	
687390-4	C	
687390-5	V	565435-5

SUPERSEDED BY 687390-1
OBSOLETE
SUPERSEDED BY 687390-5

TERMINAL NAME:	
PIN RECPT, FLAG, Ø.090	42745
	60376
	63593

CRIMPING DATA			
PAD LTR	CRIMP HEIGHT	WIRE SIZE	
A	.067 ±.002 [1.7 ±0.03]	14	
B	.063 ±.002 [1.6 ±0.03]	16	
C	.060 ±.002 [1.52 ±0.03]	18	
D	.058 ±.002 [1.47 ±0.03]	20	
CRIMP	SIZE	TYPE	RANGE
WIRE	.140	TAB LOCK	20-14
INSUL	.180	0	.120-.170
FEED	.600	APPL INST	SET UP GAGE LAYOUT
		AI 8031 & 8032	- -
TERM APPL SPEC 114-2078		WIRE STRIP LENGTH .130-.145	

-1	LEADMAKER	MECH POST FEED
-5	BENCH MODEL K	AIR FEED

QTY	REV	DESCRIPTION	ITEM NO
-	1	NUT, HEX	70
-	1	PLATE, ADJ	69
-	1	SHAFT, PIVOT	68
-	1	BUSHING	67
-	1	LEVER, INTERMEDIATE	66
-	1	BLOCK, PIVOT	65
-	1	SCR, ADJ	64
-	1	PIN, CAM ROLLER	63
-	1	ROLER, CAM	62
-	1	ROD, FEED	61
1	-	BLOCK, PIVOT	60
1	-	CAP ASSEMBLY	59
-	1	HOUSING	58
1	-	HOUSING	57
-	1	GUIDE, FEED ROD	56
1	1	PIN, FEED FINGER	55
1	1	SPRING, FEED FINGER	54
1	1	FINGER, FEED	53
-	1	LEVER, TERMINAL	52
1	-	ARM, PIVOT	51
1	-	SCREW, SHOULDER	50
1	1	BOLT, CRIMPER	49
-	1	BLOCK, INSULATION ADJUST	48
-	1	CAM, POST-FEED 1 5/8 ST	47
1	-	BLOCK, INSULATION ADJUST	46
1	1	PLUG, NYLON	45
1	-	RAM	44
1	1	WASHER, LAMINATED	43
1	1	WASHER, RAM	42
-	1	RAM	41
1	1	BALL, STEEL	40
1	1	SPRING, COMPRESSION	39
1	1	DISC, INSULATION	38
1	1	WIRE DISC, PLASTIC	37
1	1	WASHER, SPRING	36
1	1	POST, RAM	35
1	1	SPRING, HINGE BAR	34
			33
1	1	SPACER, SPRING	32
1	1	MOUNT, DRAG	31
1	1	STUD, DRAG	30
1	1	PIN, MOUNT, DRAG	29
1	1	PIN, HINGE	28
			27
1	1	PLATE, BASE	26
1	1	HINGE BAR	25
1	1	BLOCK, STABILIZER	24
1	1	BLOCK, PRESSURE	23
1	1	SPRING, DRAG	22
1	1	LEVER, DRAG	21
1	1	DRAG, STOCK	20
1	1	GUIDE, STRIP (REAR)	19
1	1	GUIDE, STRIP (FRONT)	18
1	-	SPRING, FEED RETURN	17
-	1	SPRING, FEED RETURN	16
-	1	SCREW, SHOULDER	15
			14
1	1	POSITIONER, TERMINAL	13
1	1	SPRING, TERM. POSITIONER	12
1	1	PLATE, REAR SHEAR	11
1	1	ANVIL INSERT	10
1	1	PLATE, FRONT SHEAR	9
1	1	ANVIL	8
1	1	BLADE, SLUG	7
			6
1	1	PLATE, ANVIL RETAINING	5
1	1	SPACER, TUBULAR INSUL CRIMPER	4
1	1	CRIMPER, INSULATION	3
			2
1	1	CRIMPER, WIRE	1

- 1 RECOMMENDED SPARE PARTS.
- 2 GREASE LIGHTLY.
- 3 LUBRICATE DAILY USING NO. 20 MACHINE OIL.
- 4. DO NOT EXCEED 80 C.P.M. WITH THIS APPLICATOR.
- 5 AFTER ASSEMBLY OF APPLICATOR, PROPER SPRING PRESSURE (ITEM 34) CAN BE OBTAINED BY TIGHTENING SET SCREW (ITEM 105) UNTIL CONTACT IS MADE WITH SPACER (ITEM 32) THEN TIGHTEN AN ADDITIONAL 5 1/2 - 6 REVOLUTIONS.
- 6 GUARD MUST BE IN PLACE WHEN OPERATING APPLICATOR IN A BENCH MACHINE.
- 7 ITEM NOT SHOWN

QTY	REV	DESCRIPTION	ITEM NO
2	2	PIN, WIRE DISC (.3210)D	129
2	2	PIN, WIRE DISC (.3200)C	128
2	2	PIN, WIRE DISC (.3180)B	127
2	2	PIN, WIRE DISC (.3160)A	126
1	1	WASHER, FLAT PRECISION	125
1	1	PIN, DOWEL (Ø.187X.62)	124
1	1	PIN, DOWEL (Ø.187X1.25)	123
			122
2	2	PIN, SLOTTED SPRING (Ø.094X.25)	121
2	2	PIN, SLOTTED SPRING (Ø.125X.38)	120
-	2	PIN, SLOTTED SPRING (Ø.125X.50)	119
1	1	PIN, SLOTTED SPRING (Ø.188X.75)	118
			117
-	1	WASHER, FLAT (5/16)	116
4	4	WASHER, LOCK (#8)	115
2	2	WASHER, FLAT (#8)	114
2	2	WASHER, FLAT (#10)	113
2	2	WASHER, LOCK (#10)	112
1	-	PIN, PIVOT	111
1	-	RING, SPLIT	110
1	1	NUT, HEX (5/16-24)	109
1	1	NUT, HEX (LOCKING)(10-32)	108
-	1	NUT, HEX (6-32)	107
2	2	RING, RET "C" (Ø.187)FD PIN	106
1	1	SCREW, SKT SET(5/16-24x.75)	105
7	7	SCREW, BHC (1/4-20X.63)	104
1	-	RING, RET "E" (Ø.187)	103
1	1	SCREW, SKT SET(1/4-20x.25)	102
			101
2	2	SCREW, SHC (10-32X1.00)	100
6	4	SCREW, SHC (10-32X.88)	99
1	2	SCREW, SHC (10-32X.62)	98
-	1	SCREW, SHC (10-32X.38)	97
2	2	SCREW, SHC (10-32X.38)	96
			95
2	2	SCREW, SKT SET (8-32X.25)	94
1	1	SCREW, SKT SET (8-32X.25)	93
-	2	SCREW, SHC (8-32X.20)	92
4	4	SCREW, SHC (8-32X.75)	91
2	2	SCREW, SHC (NYLON)(8-32X.62)	90
2	2	SCREW, SHC (8-32X.62)	89
4	4	SCREW, HEX HD (8-32X.62)	88
1	1	SCREW, BHC (8-32X.38)	87
2	-	SCREW, BHC (1/4-20X .62)	86
-	1	SCR, PAN HD(6-32x1.50)FEED ADJ	85
1	1	SCREW, SHC(NYLON)(6-32X.25)	84
-	1	CAP ASSEMBLY	83
			82
			81
			80
1	-	GUARD ASSY	79
1	-	AIR FEED ASSY	78
1	-	PLATE, APPL MTG	77
2	2	SCR, DRIVE (#2X.19)ID	76
1	1	PLATE, IDENTIFICATION	75
1	1	SPRING, ASSIST	74
			73
1	1	WASHER, SPECIAL	72
			71

QTY	REV	DESCRIPTION	ITEM NO
			155
			154
			153
			152
			151
			150
			149
			148
			147
			146
			145
			144
			143
			142
			141
-	2	SCR, SHC(8-32X.38)COUNTER	140
-	2	WASHER, FLAT(M4)COUNTER	139
-	2	SCR, OVAL HD(M4X12)COUNTER	138
-	1	BRACKET, COUNTER MTG	137
-	1	APPLICATOR COUNTER ASSY	136
-	2	NUT, HEX JAM(1/4-20)BRACKET	135
-	1	MAGNET, RING	134
-	1	SCR, SHC(1/4-20X1.00)BRACKET	133
-	1	BRACKET, MAGNET HOLDER	132
-	2	WASHER, LOCK (#6) BRACKET	131
-	2	SCR, SHC (6-32X.50)BRACKET	130

- 6
- 7

QTY	REV	DESCRIPTION	ITEM NO
-5	-1	U/M	DWG SIZE
REVISION OF EACH ASSY NO (WHEN BLANK, USE DWG REVISION)			
PARTS LIST			

QTY	REV	DESCRIPTION	ITEM NO
-5	-1	U/M	DWG SIZE
REVISION OF EACH ASSY NO (WHEN BLANK, USE DWG REVISION)			
PARTS LIST			

- 1
- 2
- 3
- 4
- 5
- 6
- 7
- 8
- 9
- 10
- 11
- 12
- 13
- 14
- 15
- 16
- 17
- 18
- 19
- 20
- 21
- 22
- 23
- 24
- 25
- 26
- 27
- 28
- 29
- 30
- 31
- 32
- 33
- 34
- 35
- 36
- 37
- 38
- 39
- 40
- 41
- 42
- 43
- 44
- 45
- 46
- 47
- 48
- 49
- 50
- 51
- 52
- 53
- 54
- 55
- 56
- 57
- 58
- 59
- 60
- 61
- 62
- 63
- 64
- 65
- 66
- 67
- 68
- 69
- 70

DIMENSIONS IN INCHES. DO NOT SCALE PRINT.		MATERIAL		HT TR		FIN	
TOLERANCES UNLESS OTHERWISE SPECIFIED:		DR C.ERISMAN		APP 02NOV00		T.ELBIN	
2 PLC DEC ±		CHK -		REL -		-	
3 PLC DEC ±		-		-		-	
4 PLC DEC ±		-		-		-	
ANGLES ±		-		-		-	
SURF TEXTURE: ✓		NAME		MACHINE REF		MINI APPL	
REMOVE BURRS, BREAK SHARP EDGES R.015 MAX		END FEED HINGE BAR APPLICATOR		687390		SHEET 1 OF 2	
SCALE		DWG NO		REV		V	
-		D		687390		1	

THIS DRAWING IS A CONTROLLED DOCUMENT.

THIS DRAWING IS UNPUBLISHED. DATE: 01/NOV/2000. RELEASE FOR PUBLICATION BY AMP INCORPORATED. ALL RIGHTS RESERVED. COPYRIGHT 2000.

LOC A
DIST 66

THIS DRAWING IS A CONTROLLED DOCUMENT. ANY REVISIONS TO THIS DRAWING MUST BE APPROVED BY THE ORIGINAL DRAWING ENGINEER. IT IS THE RESPONSIBILITY OF THE USER TO OBTAIN THE LATEST REVISION. ORGANIZATION SHOULD BE CONTACTED FOR THE LATEST REVISION.

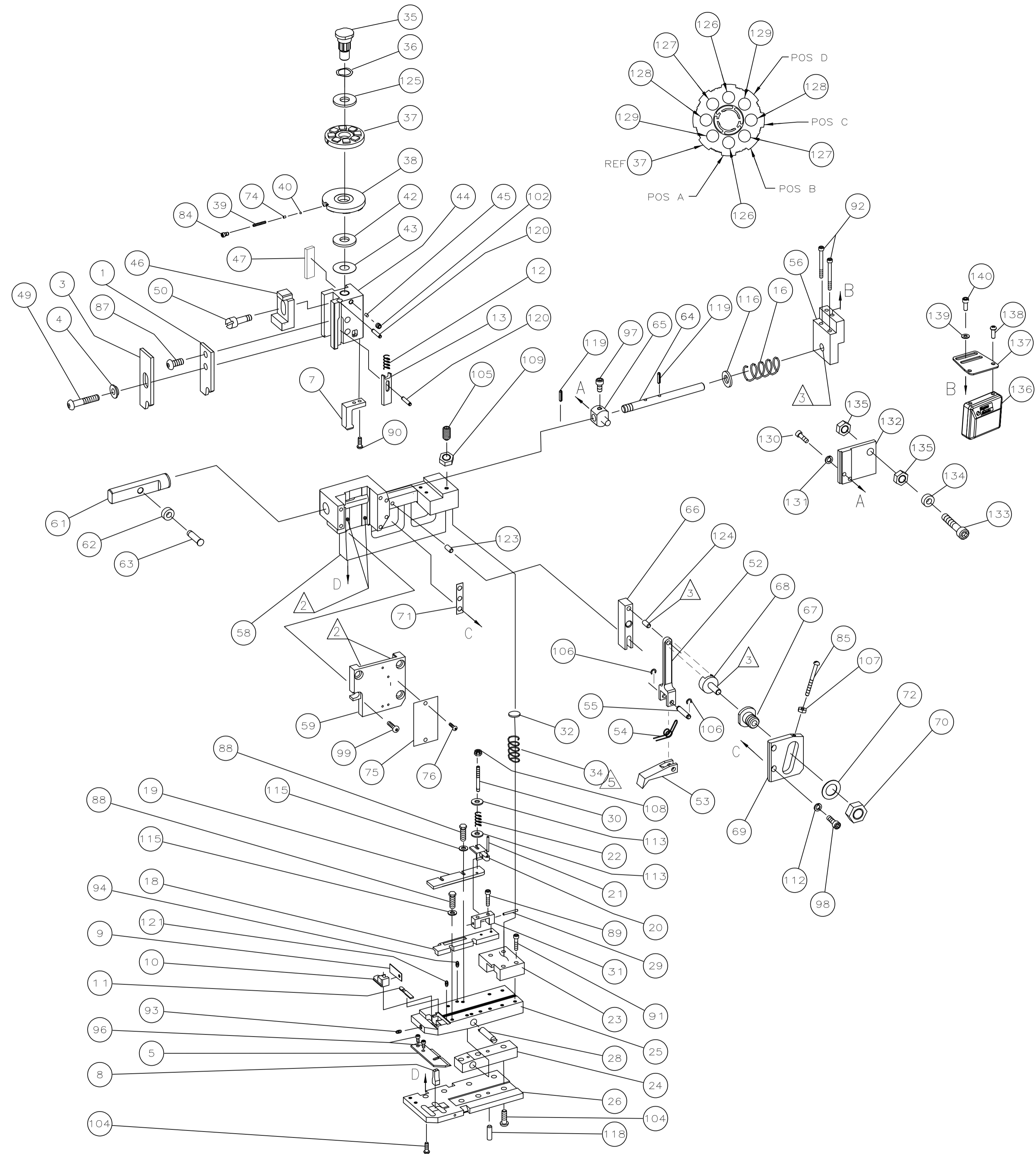

-1
(MECHANICAL FEED)

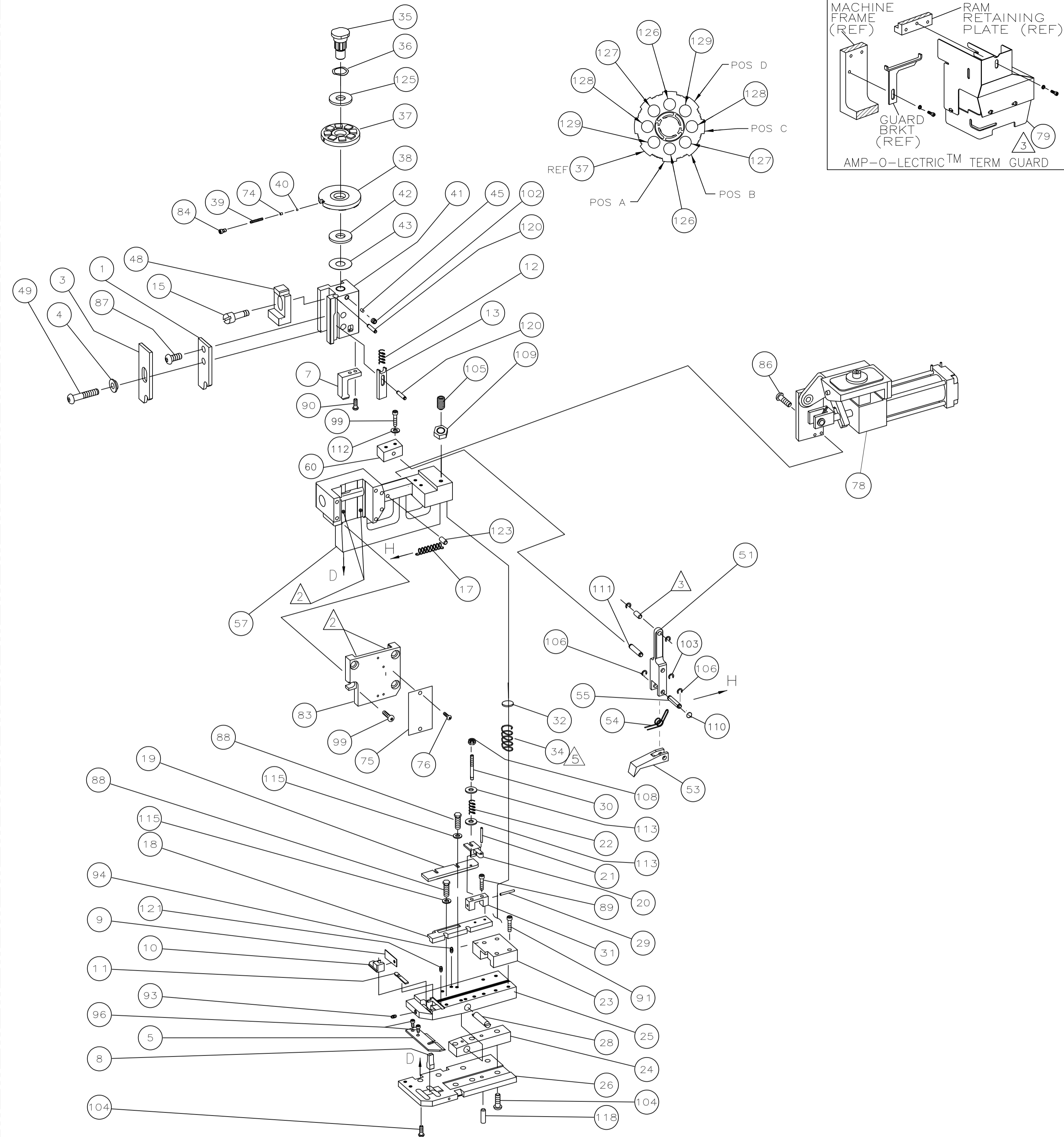

-5
(AIR FEED)

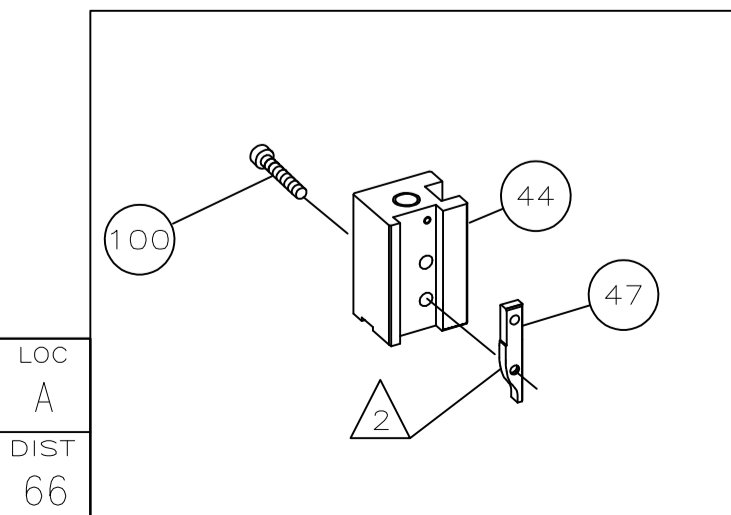
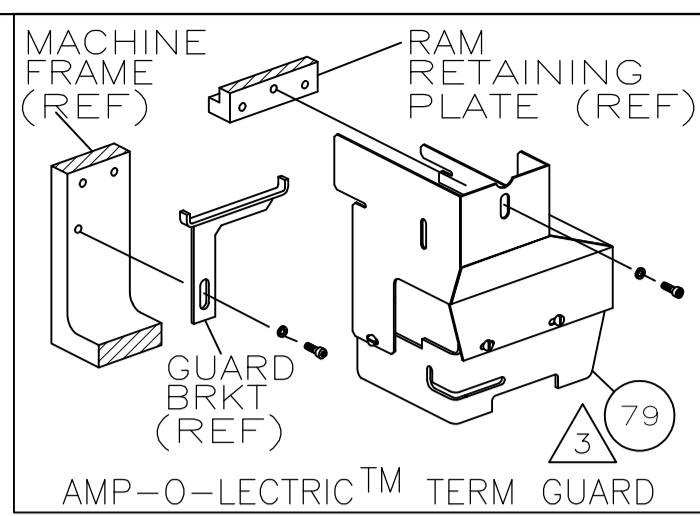

LOC
A
DIST
66

SEE SHEET	
P	F
L	T
R	R
REVISION	RECORD
APP	DATE

DWG SIZE	PART NO	DESCRIPTION	ITEM NO
QTY REQD PER ASSY			
REVISION OF EACH ASSY NO (WHEN BLANK, USE DWG REVISION)			
PARTS LIST			
MATL	HT TR	FIN	
DIMENSIONS IN INCHES. DO NOT SCALE PRINT. TOLERANCES UNLESS OTHERWISE SPECIFIED:			
DR	06NOV00	APP	06NOV00
C.E.RISMAN	T.ELBIN		
CHK	REL		
NAME			MACHINE REF
END FEED HINGE BAR APPLICATOR			MINI-APPL
SCALE	DWG NO	687390	SHEET REV
			2 OF 2 V
CAGE CODE 00779			
CUSTOMER AND ASSEMBLY DRAWING 1			
RESTRICTED TO			