

MARKING "1"

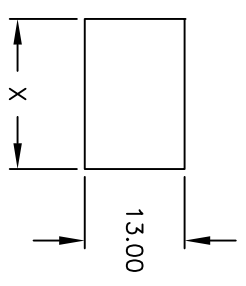

RECOMMENDED PANEL MOUNTING  
NOT TO SCALE

PANEL THICKNESS	X
0.75-1.25 (.030-.049)	19.2 (.756)
1.25-2.0 (.049-.079)	19.4 (.764)

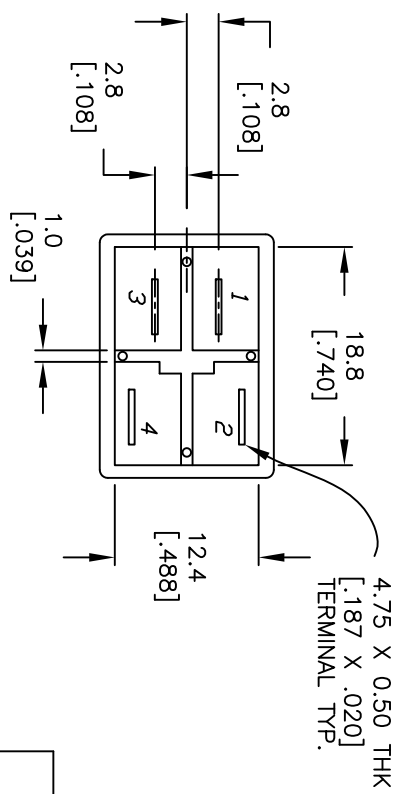
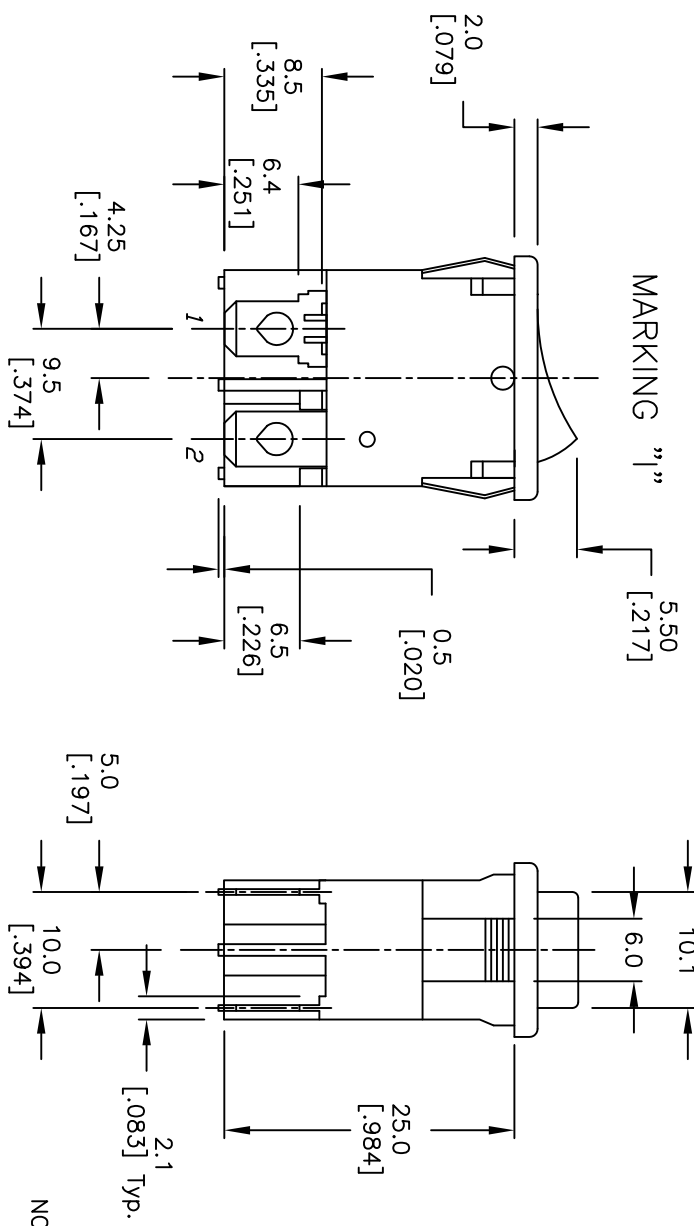
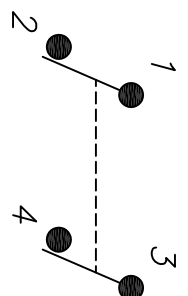

CIRCUIT: DPST

NOTES:

1. ALL DIMENSIONS IN MM [INCH]
2. GENERAL TOLERANCE: X.X=±0.4 X.XX=±0.25
3. TERM. NOS. FOR REF. ONLY
4. RATING: cRUus 8A125/250VAC
5. MECHANICAL LIFE: 15,000 cycles
6. ELECTRICAL LIFE: 10,000 cycles
7. CONTACT RESISTANCE: 10mILLI-Ohms
8. INSULATION RESISTANCE: >1000Mega-Ohms
9. DIELECTRIC STRENGTH: 1,500 Volts for 1min. 3,000 Volts between poles
10. OPERATING TEMP: -30°C to 85°C
11. HOUSING/ACTUATOR COLOR: BLACK
12. SEE DESIGNATED ROCKER MARKING
13. ▲ DESIGNATE CRITICAL PARAMETER:



C	20434	CORRECT RATING	01/27/12	BMA
B	12538	REVISED PART DESC	11/5/02	CB
REV.	ECN No.	DESCRIPTION	DATE	CHKD

TITLE		RC1083B BLK BLK IF	SCALE	1.5:1	DATE	11/5/02	DR	CB	DWG	P301504	REV	C
-------	--	--------------------	-------	-------	------	---------	----	----	-----	---------	-----	---

THE INFORMATION CONTAINED IN THIS DOCUMENT IS PROPRIETARY TO E-SWITCH AND IS NOT TO BE COPIED OR TRANSMERRED