

SPECIFICATION

Part No. : **CAB.A02**

Product Name : Taoglas Cable Assembly
SMA(F) Bulkhead Straight to
IPEX MHFIII(W.FL comp)
with 95mm \varnothing 0.81mm cable

Photo :



1.0 Cable Insertion Loss

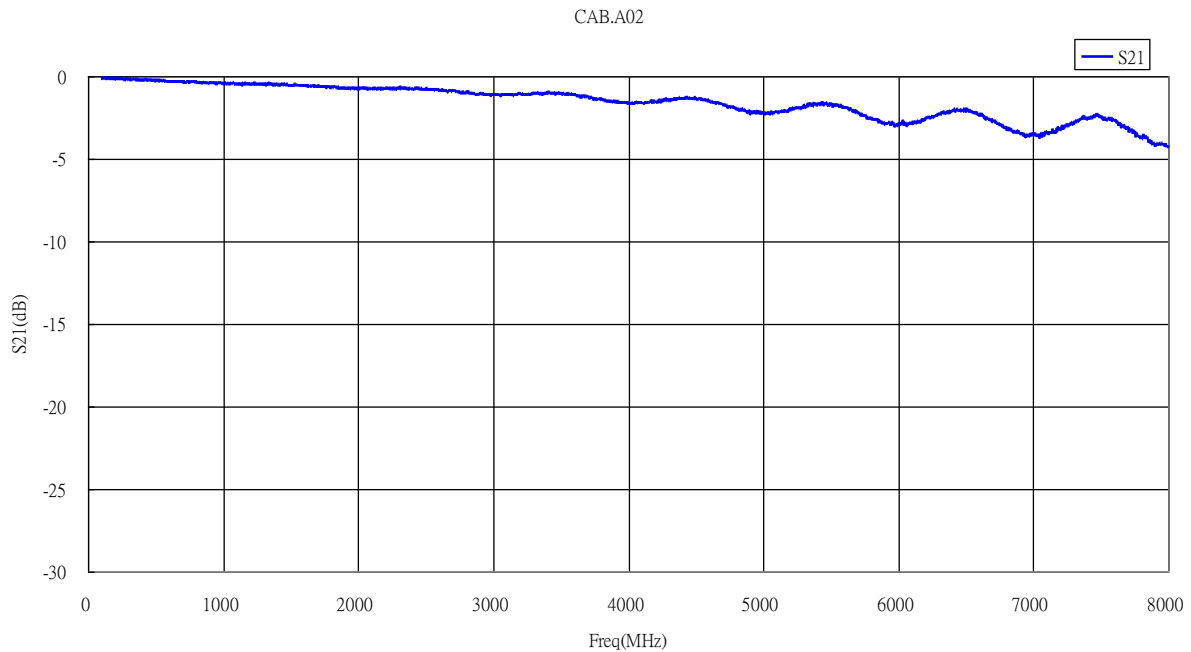

2.0 Ø0.81mm Cable Specification

2.1 Drawing – Cross Section

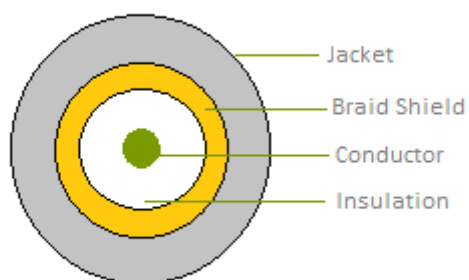

2.2 Structure and Dimensions

Structure and Dimensions

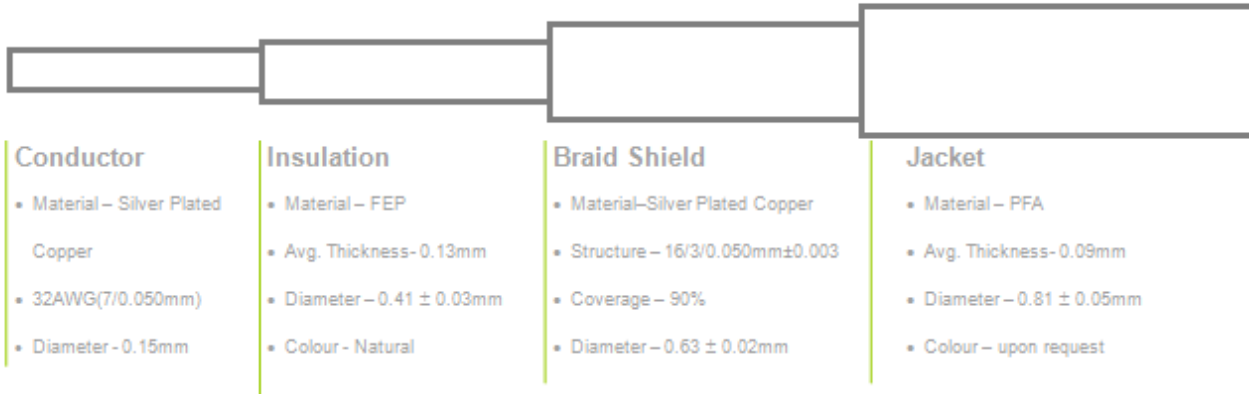

2.3 Electrical & Physical Specification

1	Insulation Resistance:	1000 MEGA OHM-KM Min.
2	Conductor Resistance:	1400 OHM/KM/20°C Max.
3	Dielectric Strength:	AC 1.0 KV/minute
4	Spark test:	2.5 KV
5	Nom. Impedance	50 ± 3 Ohms
6	Nom. Capacitance	97 ± 3 pF/m
7	Attenuation (dB/1M)	1.0GHz 3.60 2.0GHz 5.10 3.0GHz 6.20 4.0GHz 7.50 5.0GHz 8.50 6.0GHz 9.40

3.0 Technical Drawing

3.1 CAB.A02

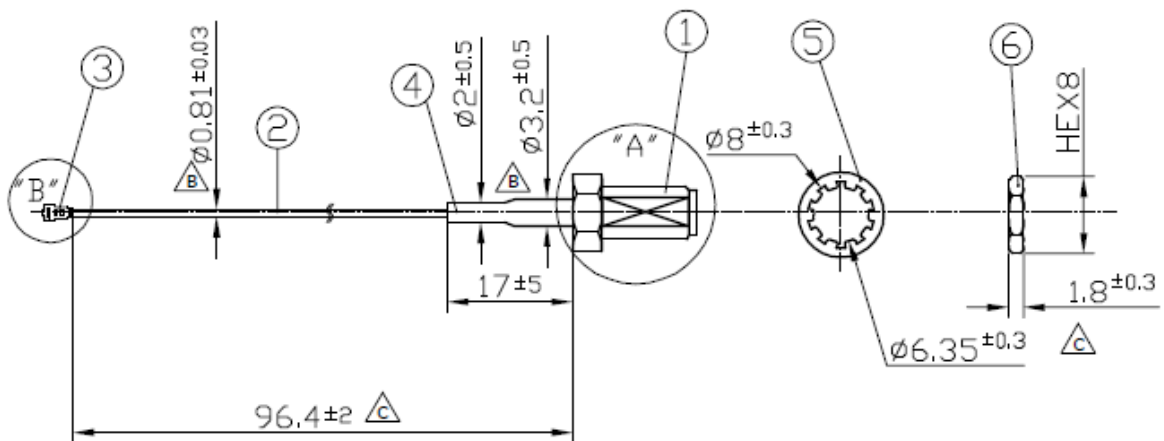
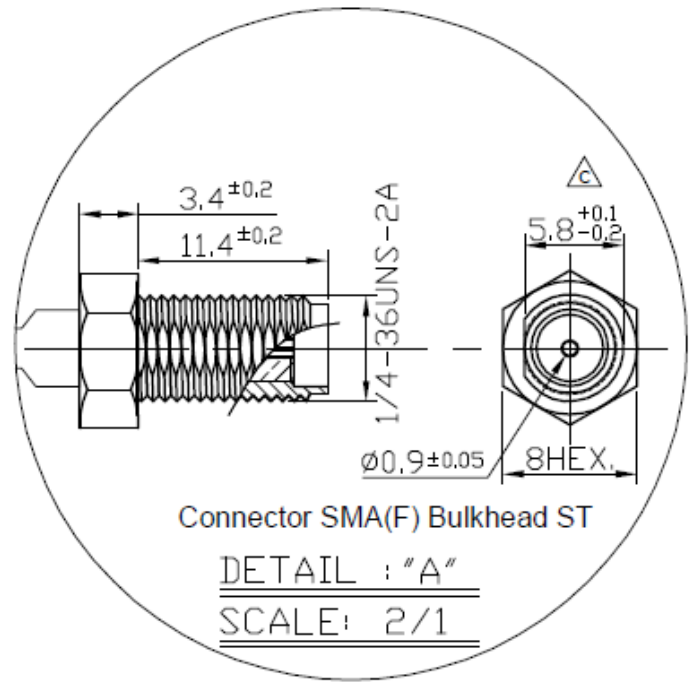
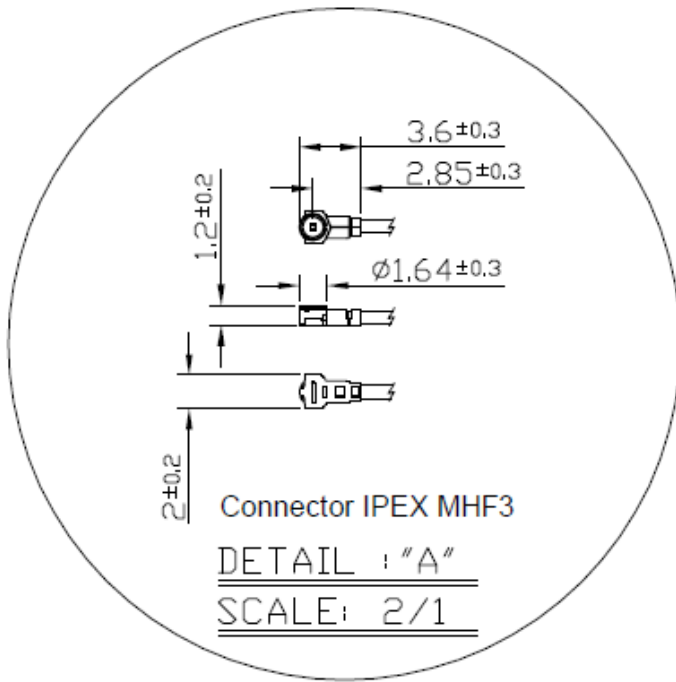

3.2 Connectors

3.2.1 SMA(F) Bulkhead Jack

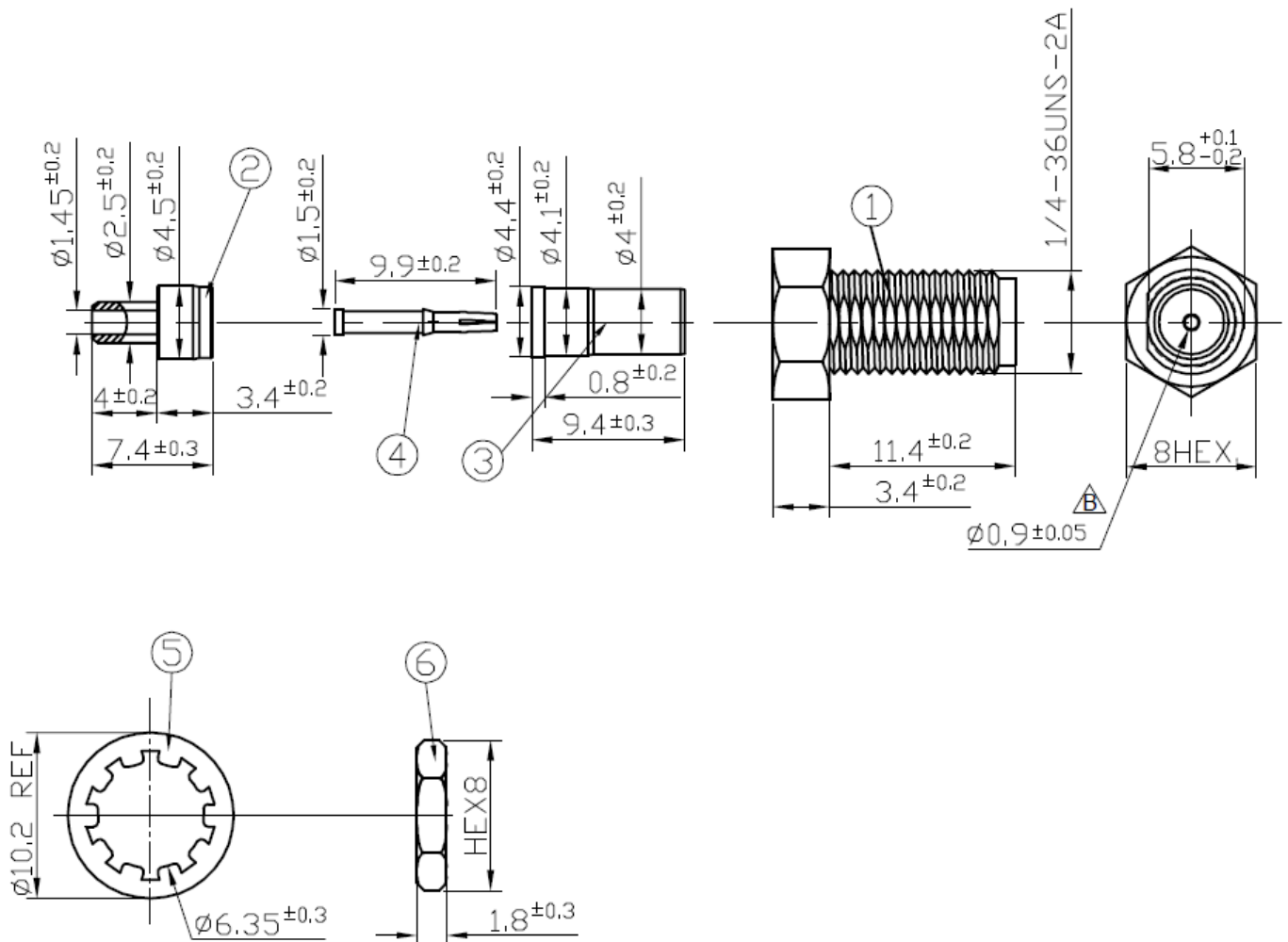

	Name	Material	Finish	QTY
1	Body	Brass	Gold	1
2	Body	Brass	Gold	1
3	Insulator	PTFE	White	1
4	Female Contact	Copper	Gold	1
5	Washer	Brass	Gold	1
6	Nut	Brass	Gold	1

1.1.2 IPEX MHFIII(W.FL comp)

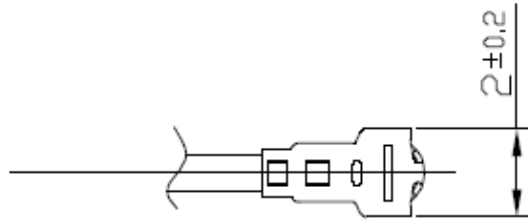

Bottom

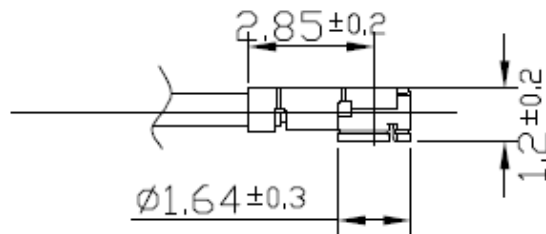

Side

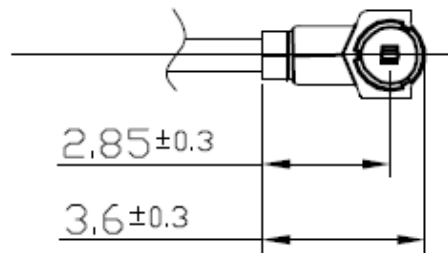

Top

Mated View

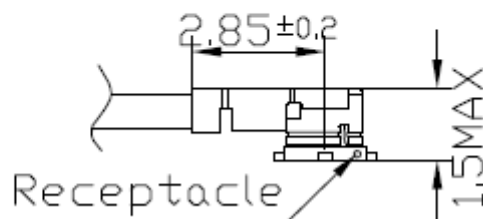

3.3 Recommended Mounting Hole – SMA(F) Bulkhead

