

	13	12	11	10	9	8	7	6	5	4	3	2	1
J	MATERIAL NUMBER	ENGINEERING NUMBER	MATERIAL NUMBER TAPE	ENGINEERING NUMBER TAPE	WIRE AWG	MWID $\triangle 4$	ID MIN	INSULATION COLOR					
	I91640010	SA-269	I91640807	SA-269T	22-18	.235/5.97	.054/1.37	RED					
	I91640040	SB-289	I91640315	SB-289T	16-14	.264/6.71	.080/2.03	BLUE					

(A)

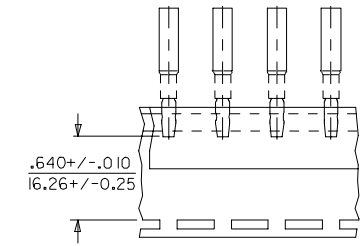

PARTS ON TAPE

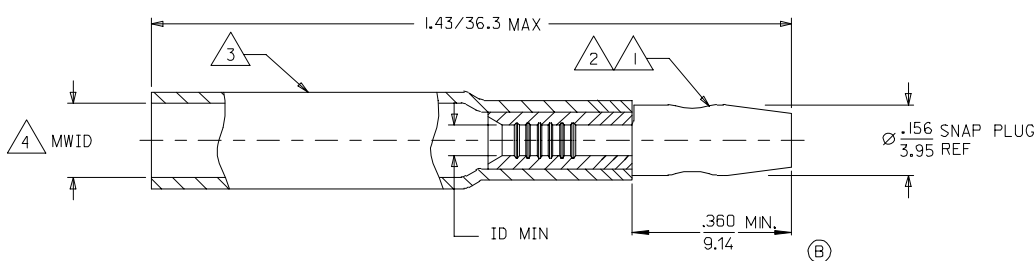

(B)

SALES DRAWING

NOTES:

- $\triangle 1$ TERMINAL MATERIAL: COPPER ALLOY
- $\triangle 2$ FINISH: ELECTRO TIN PLATE.
- $\triangle 3$ INSULATION MATERIAL: HEAT SHRINKABLE TUBING WITH HOTMELT ADHESIVE INNER LINER. COLOR: SEE CHART
- $\triangle 4$ MWID = MAXIMUM WIRE INSULATION DIAMETER.

RELEASED FC NO: ETC2007-0054 DRWN: JLOMASTRO 2006/08/16 CHKD: RDEROSS 2006/08/16 APPR: JMACNEIL 2006/08/17 REVISION DESCRIPTION	QUALITY SYMBOLS	GENERAL TOLERANCES (UNLESS SPECIFIED)		DIMENSION STYLE	SCALE	DESIGN UNITS	THIRD ANGLE PROJECTION	
	$\nabla = 0$ $\nabla = 0$	mm	INCH	IN/MM	---	INCH		
		4 PLACES ± ---	± ---	ASAYDEH	DATE	TITLE		
		3 PLACES ± ---	± ---	CHECKED BY	DATE	.156 BULLET PLUG PERMA-SEAL		
	2 PLACES ± ---	± ---	JLOMASTRO	05/12/13	MOLEX INCORPORATED			
	1 PLACE ± ---	± ---	APPROVED BY	DATE	MATERIAL NO. DOCUMENT NO. SHEET NO.			
	ANGULAR ± --- °	± --- °	RDEROSS	05/12/13	SD-19164-031 1 OF 1			
			DRAFT WHERE APPLICABLE MUST REMAIN WITHIN DIMENSIONS		SEE CHART			
			THIS DRAWING CONTAINS INFORMATION THAT IS PROPRIETARY TO MOLEX INCORPORATED AND SHOULD NOT BE USED WITHOUT WRITTEN PERMISSION					