

PART No	"A" WIRE BUNDLE DIA.	"B" APPROXIMATE HEIGHT
KL-125	.125-.150 (3.2-3.8)	.48 (12.2)
KL-200	.16-.24 (4.1-6.1)	.82 (20.7)
KL-250	.20-.30 (5.1-7.6)	.91 (23.0)
KL-350	.30-.40 (7.6-10.2)	1.03 (26.2)
KL-450	.40-.50 (10.2-12.7)	1.20 (30.5)
KL-600	.55-.65 (14.0-16.5)	1.25 (31.8)
KL-750	.70-.80 (17.8-20.3)	1.52 (38.6)
KL-950	.90-1.00 (22.9-25.4)	1.75 (44.5)

THRU HOLE MAY NOT
APPEAR ON ALL PARTS

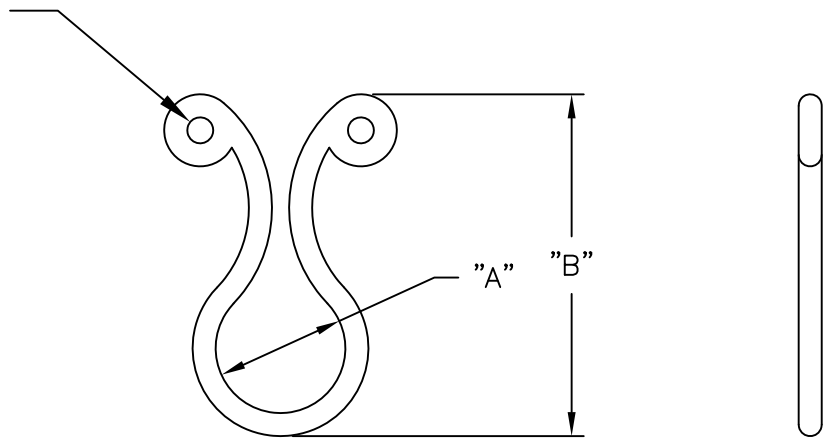

- NOTE
1. MATERIAL: NYLON 6/6 (RMS-01).
FLAME RETARDANT, NYLON (RMS-19),
AVAILABLE BY SPECIAL ORDER ONLY.
SPECIFIED MATERIALS COMPLY WITH STANDARD SS-00259-1.
 2. COLOR: NATURAL.
OTHER COLORS AVAILABLE BY SPECIAL ORDER ONLY.

H	SEE CO 200214 FOR CHANGES	SK 08.19.08	TITLE: KURLY LOK-SERIES		DWG IN IN (MM)	
G	SEE ECN #649 FOR CHANGES	SM 06.17.03				
F	SEE ECN #596 FOR CHANGES	SM 03.12.03				
E	CHANGED FILE NUMBER	SM 05.31.01	FILE # KL	DWN: J.P.	APP:	FINAL
D	ADDED OTHER COLOR BY SPECIAL ORDER	JL 3.7.00	MAT'L: SEE NOTES	DT: 02-11-91	DT:	PART # SEE TABLE
C	ADDED RMS-19	JL 3.3.00	RE: RICHCO, INC.	RICHCO INC. PO BOX 804238, CHICAGO, 60680 (773) 539-4060		
B	ADDED KL-200	JL 9.17.97	TOLERANCES UNLESS NOTED .XX=±.010 .XXX=±.005 FRAC=±1/64 ANG=±1'			
A	ADDED KL-125 TO PART #S	JB 11.17.95				
REV	DESCRIPTION	ENGR DATE				