

REVISIONS			
REV	DESCRIPTION, ECN, EAR NO.	DATE	APP'D
K	UPDATE DESCRIPTION	APR06/16	JS

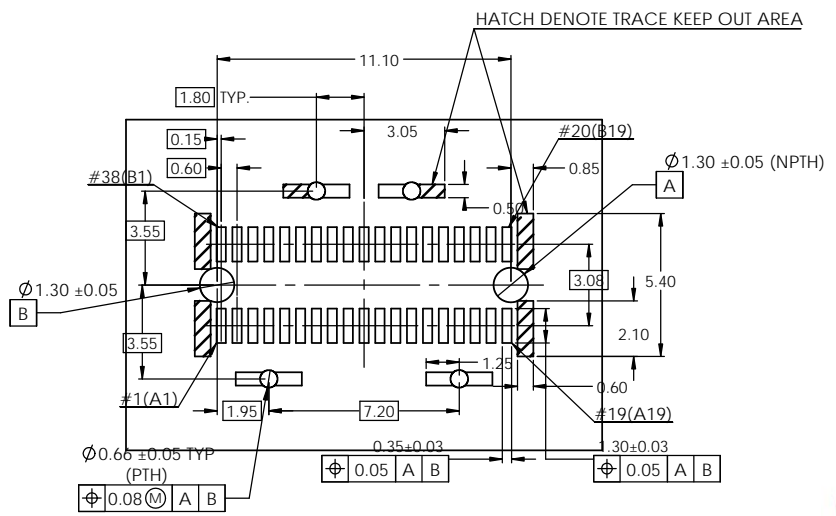

NOTES:  
 1) MATERIAL:  
 HOUSING: SOLDER REFLOW PROCESS COMPATIBLE LCP, UL94V-0  
 CONTACTS: HIGH PERFORMANCE COPPER ALLOY  
 LATCH: PHOSPHOR BRONZE  
 RESONANCE DAMPENING FEATURE: SEMI-CONDUCTIVE POLYMER  
 2) RoHS COMPLIANT

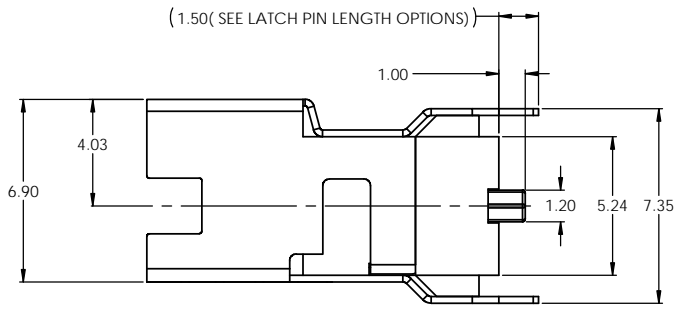
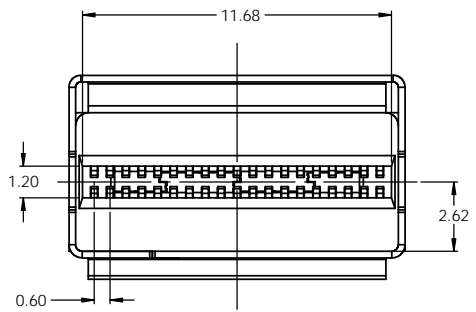
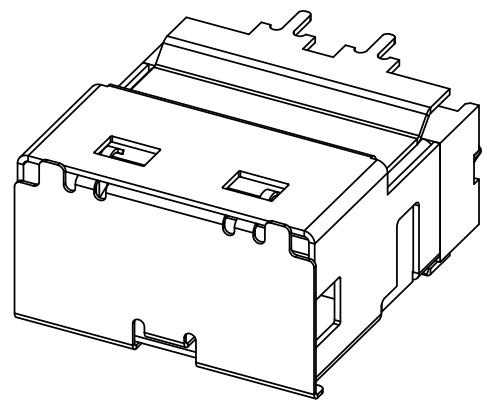
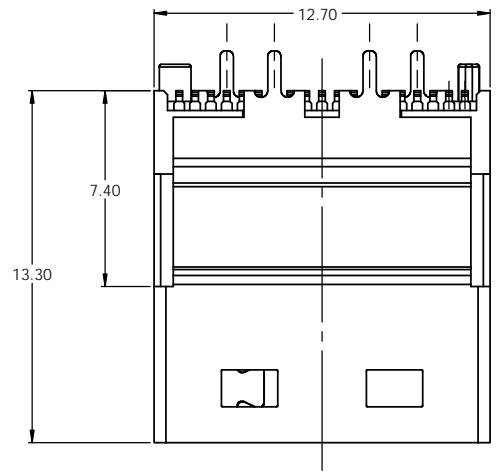

U10 - D038 - X X X X

- OPTIONS**  
**0I** = STANDARD CONSTRUCTION (24G) WITH TAPE & REEL PACKAGING  
**1I** = NO RESONANCE DAMPING FEATURE (12G) WITH TAPE & REEL PACKAGING
- LATCH PTH PIN LENGTH OPTIONS**  
**0** = 1.50  
**1** = 2.20  
**8** = 3.00  
**9** = 4.20
- CONTACT PLATING OPTIONS**  
**2** = 30 MICROINCHES OF GOLD ON MATING END WITH 100 MICROINCHES MINIMUM OF MATTE TIN ON SOLDER TERMINATION. 50-75 MICROINCHES OF NICKEL UNDERPLATE ALL OVER  
**3** = 15 MICROINCHES OF GOLD ON MATING END WITH 100 MICROINCHES MINIMUM OF MATTE TIN ON SOLDER TERMINATION. 50-75 MICROINCHES OF NICKEL UNDERPLATE ALL OVER

UNLESS SPECIFIED OTHERWISE	DRAWN	A.ALIM	DEC04/13
PRIMARY UNITS MILLIMETERS	CHECKED	BA P	SEP12/14
SECONDARY INCHES	M.E. APP'D		
REFERENCE IN PARENTHESES	Q.A. APP'D		
GENERAL TOLERANCES	DWG APPR.	ZLJ	DEC04/13
1 DECIMAL PLACE ±0.35	ENG. REL. NO.	ECN TBD	
2 DECIMAL PLACES ±0.25	REF.		
3 DECIMAL PLACES ±0.15	THIRD ANGLE PROJECTION		
ANGULAR DEGREES ±2°	DO NOT SCALE DRAWING		

**Amphenol High Speed Interconnects**  
 A Division of Amphenol Corp. www.amphenolcanada.com

**ULTRAPORT SLIMSAS™ 4X24 VERTICAL RECEPTACLE WITH PIN INSIDE LATCH**

DWG. NO. **P-U10-D038-XXXX** REV **K**

CODE ID NO. **03554** DWG SIZE: **C** SCALE: **7** SHEET 1 OF 1