

## SUMMARY

### # Wires

Low	2
High	2
Coax	0
Triax	0
Quad	0
Fiber	2
Fluidic	0



*Image is for illustrative purpose only*

### Download

[Request a quote](#)

[Catalog](#)

Series	3K
Termination type	Hybrid contacts
IP rating	68
Cable Ø	8.60 - 9.50 mm
Matching parts	FGW.3K.93C.TLMT96Z
Status	
Alternative part	

## TECHNICAL DETAILS

### Mechanics

Shell Style/Model	PB*: Fixed receptacle with rear square flange (4 hole fixing), cable adapter, with bend relief nut
Keying	5 keys (alpha=95, beta=115, gamma=20, delta=30, plug: female LV, male HV, female FO contacts)
Housing Material	Stainless steel shell, collet nut and latch sleeve, nickel plated brass mid pieces
Cable Fixing	T96: 8.6 - 9.5 mm
Variant	Z : Nut for fitting a bend relief

### Performance

Configuration	3K.93C : 2 FO Type F2, 2 HV + 2 LV
Insulator	L: PEEK (UL 94 / V-0/3.2, depends on material thickness)
Rated Current	10 Amps

### Specifications

Contact Type:	Crimp
Fiber Optic Contact:	Type F2
Vtest power/signal (AC):	2250V , 1000V
Working voltage power/signal(AC):	600V , 42V

Cable type: SMPTE 311M or EBU R100

## Others

Endurance (Shell): 5000 mating cycles  
Temp (min / max): -55°C / +200°C  
Humidity (max): ≤95% [at 60 deg C / 140 F]  
Vibration: 15 g [10 Hz - 2000 Hz]  
Shock Resistance: 100 g [ 6 ms]  
Salt Spray Corrosion: >1000 hr  
Climatical Category: 50/175/21  
Shielding (min): 95 dB (10 MHz)  
Shielding (min): 80 dB (1 GHz)  
IP Rating: 68

---

## DRAWINGS

### Draws

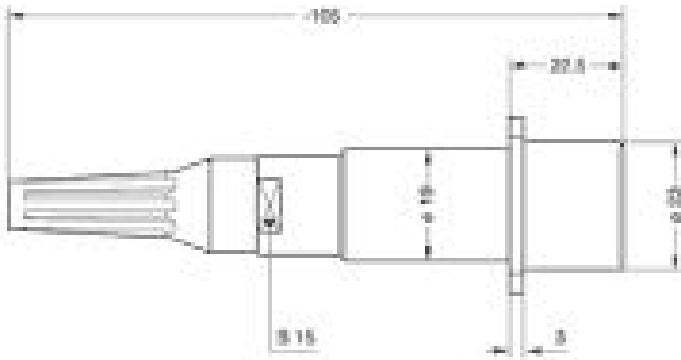

### Dimensions

	A	L
mm.	23	105
in.	0,91	4,13

---

## RECOMMENDED BY LEMO

### Tools

Crimp Tool: DPC.91.701.V  
Crimp Tool 2: DPC.91.101.A  
Crimp settings: AWG/Selector = 20-22-24 14-16-18/6-5-5 7-6-5  
Positionner: DCE.91.093.BVC

Positionner 2: DCE.91.133.BVCW  
Extractor: DCF.91.093.5LT  
Extractor 2: DCF.91.133.5LT  
Fiber Tool: WST.KI.125.34  
Fiber Tool 2: DCB.91.119.0TN  
Replacement contact: FGG.3B.560.ZZC / EGW.3K.666.ZZM  
Spanner wrench: DCD.3E.030.PA150

## Cables

CFN.3K.93C.092PNCA	PVC	Black	
CFN.3K.93C.092PNCS	PVC	Black	