

Outline

Standard Gearbox

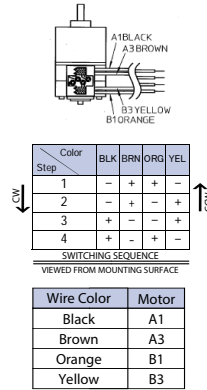
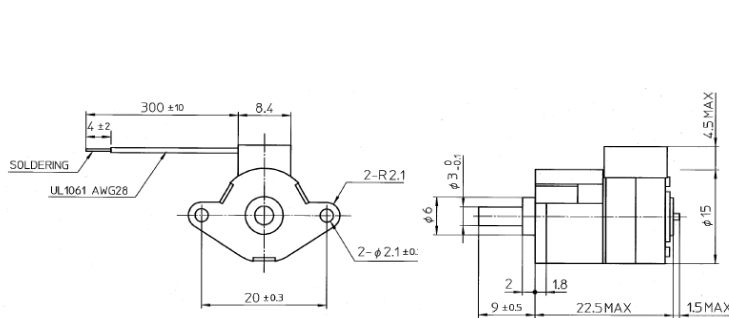

PG

*Please contact our sales for inventory and lot information. Specification may be changed without notice.

Specifications

Model	Step Angle	Drive Method	Drive Mode	Drive Voltage	Surge/Current	Coil Resistance	Drive IC
PG15S-D20-HHB9	0.176°	2-2 Phase	Bipolar Chopper	15 [V]	/100 [mA]/Phase (Peak)	10 [Ω]	UDN2916B-V

Magnet Material	Stator Material	Shaft Length	Wire Length	Wire Holder	Gear Ratio	Electrical
MS70A	SECC	9mm	300mm fly lead (no connector)	90 deg. Left	1/102.5	15V, 100mA Bipolar Constant Current

Note: Current adjust by 0 pps., GEAR RATIO 1/102.5
MAES8U4 STA9Z03

Torque/Speed Characteristics

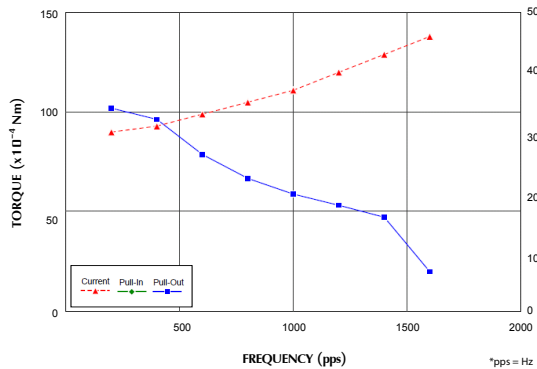

Frequency (pps)	200	400	600	800	1000	1200	1400	1600
Pull-Out (x10 ⁻⁴ Nm)	102.0	96.1	78.5	66.7	58.8	53.0	47.1	19.6
Pull-In (x10 ⁻⁴ Nm)								
Current (mA)	30	31	33	35	37	40	43	46

Markings

Japan

NMB-MAT PG15S-D20-HHB9
JAPAN H0106

Thailand

NMB-MAT PG15S-D20-HHB9
THAILAND TA0106

Print mark on stator assy by inkjet printer