

1

2

3

4

5

6

7

A

NOTES:**1. Material:**

1.1 Housing: PBT+30%GF UL94V-0, Color Blue

1.2 Shell: Brass

1.3 Contact :Copper Alloy

2. FINISH:

2.1 Contact Area: Selective 15u"Au

Solder Area: Tin Plated

Under: Ni Plated

3. MECHANICAL:

3.1 Mating Force:3.57kgf Max.

3.2 Unmating Force:1.02kgf Min

③ 3.3 Durability:5000 cycles Min

4. ELECTRICAL:

③ 4.1 Current Rating:1.5A

4.2 Dielectric Strength:100V AC FOR 1 MINUTE

4.3 Contact Resistance:30mΩ Max

4.4 Insulation Resistance:100 MΩ Min

5. Operating temperature: -55°C TO +85°C

6. PACKING: Tray

A

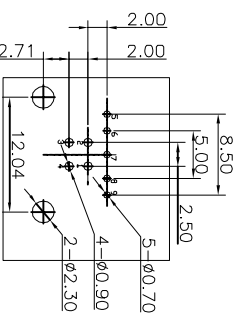
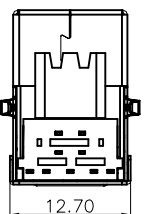
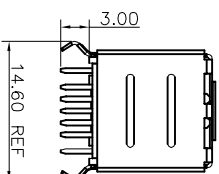
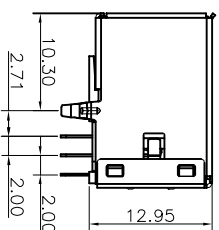
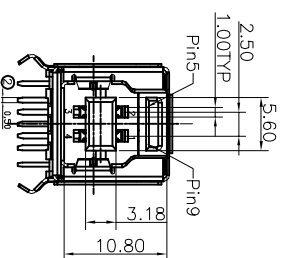
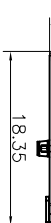
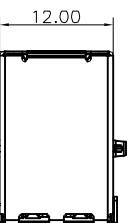
RECOMMENDED P.C.B LAYOUT
(TOLERANCE:±0.05)

D

E

E

F

F

G

G

RoHS compliant

Scale	Free			Date	Name	Customer-No.
TOLERANCE						
.X	±0.30			07.06.2013	Winnie	ASSMANN WSW-No. ① AU-Y1007-3
.XX	±0.20			12.01.2015	Winnie	
.XXX	±0.10	②	Add the width of pin	15.10.2014	Winnie	Drawing-No. ASS 5779 CO
DIM	TOL	①	Change the P/N/AU-Y1007-3-R to AU-Y1007-3	11.06.2014	Winnie	
X. °	±5°					
Angle	TOL	①	Drawn	07.06.2013	Winnie	
UNIT	mm		Modification			Replace

1

2

3

4

5

6

7

H

 WSW/ components

 ASSMANN WSW/ components
 ASS 5779 CO
 rev03
 SHEET