

P.C. MOUNTING

SWITCH FUNCTION	POS. 1	POS. 2	POS. 3
ON	OFF	ON	
2-1, 5-4	OPEN	2-3, 5-6	

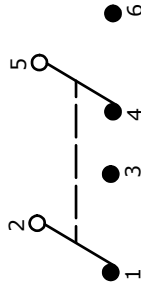

- NOTE:
1. ALL DIMENSIONS IN MM [INCH]
 2. GENERAL TOLERANCE: X.X=±0.4
X.XX=±0.25
 3. TERMINAL NUMBERS FOR REF ONLY
 4. PLATING MATERIAL: SILVER
 5. CONTACT RATING: 2A @ 250VAC
5A @ 120VAC OR 28VDC
 6. ELECTRIC LIFE: 30,000 ACTUATIONS AT FULL LOAD.
 7. INSULATION RESISTANCE: 1,000 MEGA-OHM MIN.
 8. DIELECTRIC STRENGTH: 1,000 V RMS @SEA LEVEL.
 9. OPERATING TEMP.: -30°C to 85°C
 10. ▲ DENOTES CRITICAL PARAMETER.
 11. 2002/95/EC (ROHS) COMPLIANT
 12. CONTACT RESISTANCE: 10 mΩ OHM MAX. INITIAL @ 2-4 VDC
100mA FOR BOTH SILVER AND GOLD PLATING

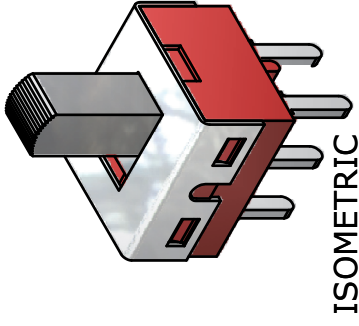
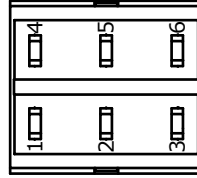
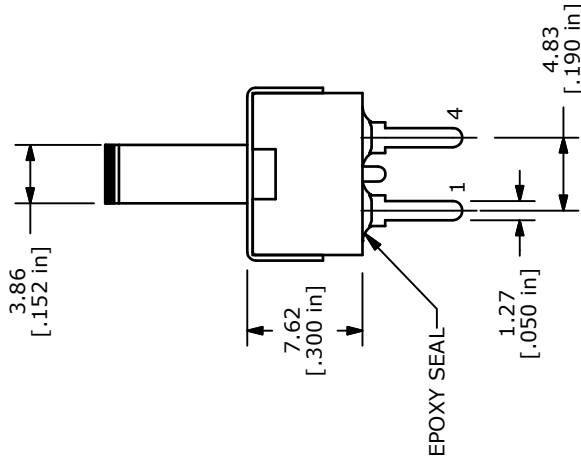
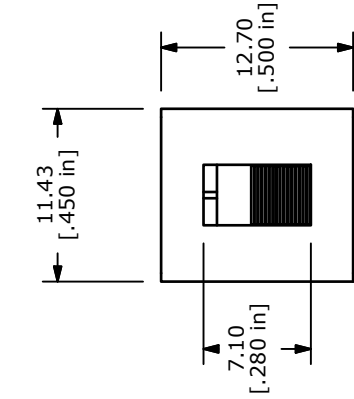

ISOMETRIC

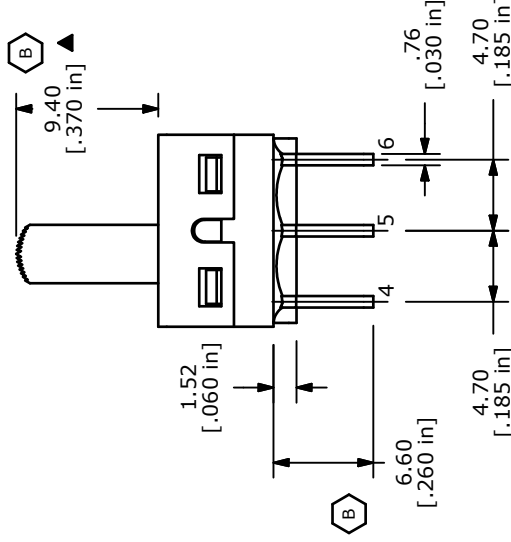

E-SWITCH®

TITLE 500SDP3S4M2QE A

B	19565	DRAWING UPDATE	1/6/11	BGL
REV	PCR NO	DESCRIPTION	DATE	BY

THE INFORMATION CONTAINED IN THIS DOCUMENT IS PROPRIETARY TO E-SWITCH AND IS NOT TO BE COPIED OR TRANSFERRED

SCALE	2:1	DATE	1/6/2011	DR	BGL	DWG	T521013	REV	B
-------	-----	------	----------	----	-----	-----	---------	-----	---