

THIS IS A CONTROLLED DOCUMENT
AMP
COPYRIGHT 2000
DIMENSIONS IN INCHES DO NOT SCALE PRINT

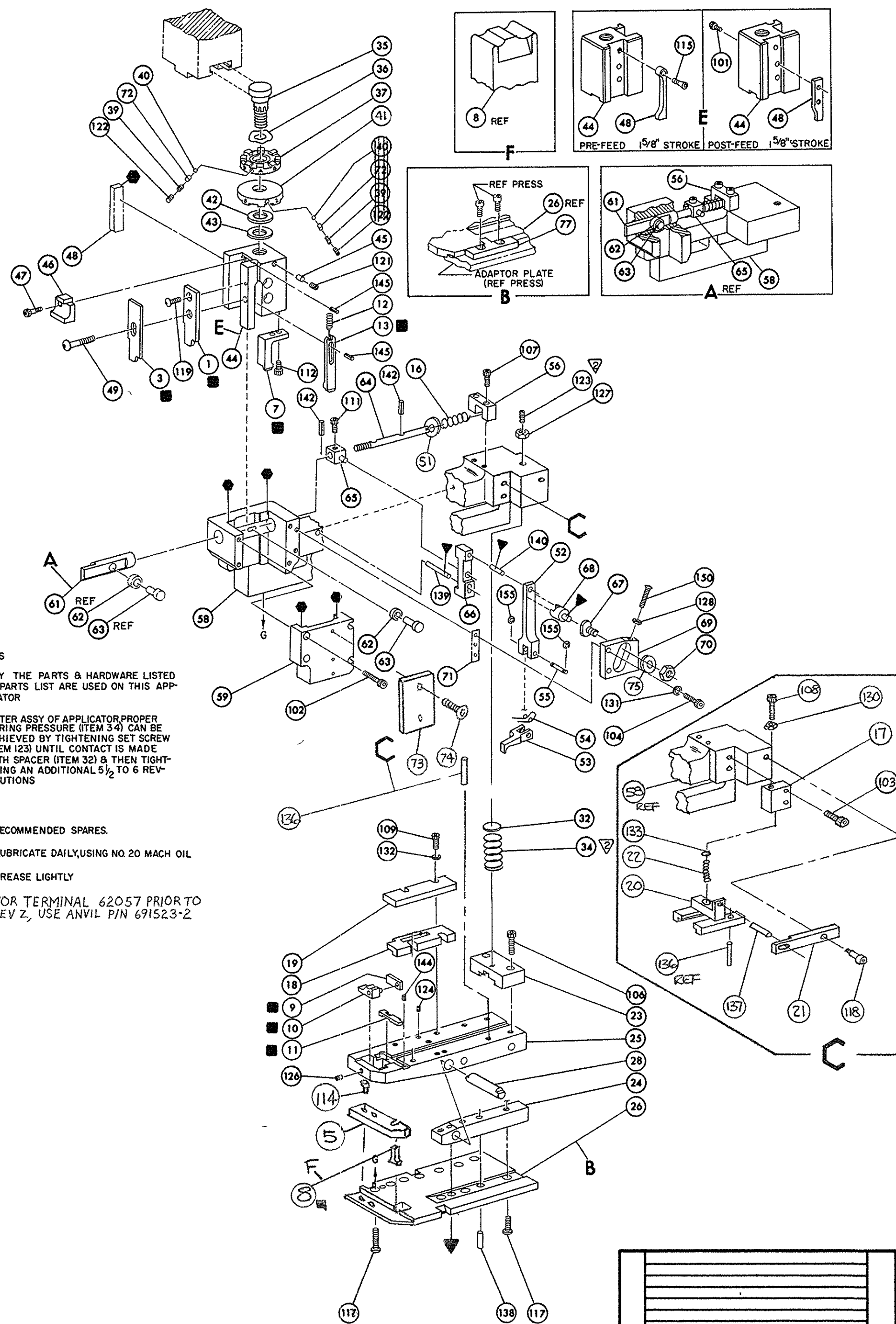

NOTES

1 ONLY THE PARTS & HARDWARE LISTED ON PARTS LIST ARE USED ON THIS APPLICATOR

2 AFTER ASSY OF APPLICATOR PROPER SPRING PRESSURE (ITEM 34) CAN BE ACHIEVED BY TIGHTENING SET SCREW (ITEM 123) UNTIL CONTACT IS MADE WITH SPACER (ITEM 32) & THEN TIGHTENING AN ADDITIONAL 5/2 TO 6 REVOLUTIONS

KEY

■ - RECOMMENDED SPARES.

▼ - LUBRICATE DAILY, USING NO. 20 MACH OIL

● - GREASE LIGHTLY

△ FOR TERMINAL 62057 PRIOR TO REV Z, USE ANVIL P/N 691523-2

REQ.	PART NO.	DESCRIPTION	NO	REQ.	PART NO.	DESCRIPTION	NO.
	162		1	690517-1	SPACER	71	
	161		1	22594-8	NUT, HEX	70	
	160		1	240628-1	PLATE, ADJUSTMENT	69	
	159		1	240626-1	SHAFT, PIVOT	68	
	158		1	240633-1	BUSHING	67	
	157		1	240630-1	LEVER, INTERMEDIATE	66	
	156		1	240629-1	BLOCK, PIVOT	65	
2	21045-3	RING RET "C" (3/16 DIA) FEED PIN	155	1633286-1	SCREW, ADJUSTMENT	64	
			154	240659-3	PIN, CAM ROLLER	63	
			153	240658-1	ROLLER, CAM	62	
			152	240634-1	ROD, FEED	61	
			151			60	
1	3- 21064-1	SCREW RD HD MACH (6-32 X 1 25) FEED ADJ.	150	455164-1	CAP, HOUSING	59	
			149	458984-1	HOUSING	58	
			148			57	
			147	458361-1	GUIDE, FEED ROD	56	
			146	240624-1	PIN, FEED FINGER	55	
2	4- 21028-9	PIN SLOTTED SPRING (1/8 DIA X 38) RAM	145	691499-1	SPRING, FEED FINGER	54	
1	3- 21028-2	PIN, SLOTTED SPRING (3/32 DIA X 25) REAR SHEAR PLATE	144	690584-5	FINGER, FEED	53	
			143	240634-1	LEVER, TERMINAL	52	
2	5- 21028-1	PIN, SLOTTED SPRING (1/8 DIA X 50) SCREW ADJ. ROD	142	21899-4	WASHER, FLAT 5/16	51	
			141			50	
1	1- 21030-1	PIN, DOWEL (3/16 DIA X .50) LEVER	140	3-21002-5	BOLT, CRIMPER	49	
1	1- 21030-6	PIN, DOWEL (3/16 DIA X 1 25) HOUSING	139	238015-1	CAM POST FEED 1 5/8 STROKE	48	
1	21029-5	PIN, SLOTTED (3/16 DIA X .75) BASE PLATE	138	22353-8	SCREW, SHOULDER	47	
1	21029-3	PIN, SLT SPRING (1/8 DIA X .62 LG) DRAG	137			46	
2	1-21030-6	PIN, DOWEL (.187 X 1.25 LG) DRAG	136	690191-1	PLUG, NYLON	45	
			135	691533-1	RAM	44	
			134	690125-1	WASHER, LAMINATED	43	
1	21899-1	WASHER, FLAT (#6) DRAG STUD	133	1-690124-1	WASHER, RAM	42	
4	21024-4	WASHER, LOCK (#8) STRIP GUIDE	132	690223-1	SPACER, INS.	41	
2	21024-5	WASHER, LOCK (#10) FEED ADJ. PLATE & RET. PLATE	131	23241-6	BALL, STEEL	40	
1	21018-7	NUT, HEX #10 DRAG	130	690170-1	SPRING, DISC.	39	
			129			38	
1	21068-5	NUT, HEX MACH (6-32) FEED ADJ.	128	3-6900972-6	DISC., WIRE	37	
1	1- 22202-7	NUT, HEX MACH (5/16-24) SPRING HOUSING	127	22480-5	WASHER, SPRING	36	
			126	690212-1	POST, RAM	35	
1	21061-9	SCREW SKT. SET (8-32 X .25) ANVIL INSERT	125	3- 23846-5	SPRING, HINGE BAR	34	
2	4- 21006-0	SCREW SKT. SET (8-32 X 25) HINGE PIN	124			33	
1	8- 21007-5	SCREW SKT. SET (5/16-24 X .75) SPRING HOUSING	123	690573-1	SPACER, SPRING	32	
2	23030-1	SCREW, SKT. HD. CAP. (NYLON) (6-32 X 25) C P. DISC.	122			31	
1	21009-2	SCREW SKT SET (1/4-20 X .25) C.P. RAM	121			30	
			120			29	
1	2- 21002-2	SCREW BTN HD. SKT. CAP (8-32 X .50) CRIMPER	119	690582-1	PIN, HINGE	28	
1	1-22353-9	SCREW, SHLD. SLT. HD. 250 X 250 DRAG	118			27	
7	2-22733-8	SCREW BTN HD. SKT. CAP (1/4-20 X .62) BLOCK, STABILIZER LOC WEL	117	463873-1	PLATE, BASE	26	
			116	691535-2	BAR, HINGE	25	
			115	690571-1	BLOCK, STABILIZER	24	
2	7-21000-6	SCREW SKT CAP 10-32 X 3/4 ANVIL MTG. PL.	114	814222-1	BLOCK, PRESSURE	23	
2	2- 21000-8	SCREW SKT. HD CAP (8-32 X .62) DRAG MOUNT	113	1-22282-5	SPRING, DRAG	22	
			112	458968-1	LEVER, DRAG	21	
1	3- 21000-4	SCREW SKT. HD CAP (10-32 X .38) PIVOT BLOCK	111	458960-1	DRAG, STOCK	20	
			110	691530-3	GUIDE, STRIP, REAR	19	
4	2-22603-3	SCREW HEX HD (8-32 X 62) REAR STRIP GUIDE	109	691529-2	GUIDE, STRIP, FRONT	18	
1	3-21000-9	SCREW, SKT. HD. CAP (10-32 X 1.00) DRAG	108	458978-1	BLOCK, SPRING	17	
1	3- 21000-0	SCREW SKT. HD CAP (8-32 X .38) FEED ROD GUIDE	107	4-22284-9	SPRING, FEED RETURN	16	
2	2- 21000-9	SCREW SKT. HD CAP (8-32 X .75) PRESS BLOCK	106			15	
			105			14	
2	3- 21000-6	SCREW SKT HD CAP (10-32 X .62) FEED PLATE	104	692134-7	POSITIONER, TERMINAL	13	
2	2-21000-9	SCREW SKT. HD. CAP (8-32 X .75) DRAG	103	5- 22280-5	SPRING, TERM, POSITIONER	12	
4	3- 21000-8	SCREW SKT. HD CAP (10-32 X 88) HSG. CAP	102	691525-3	PLATE, REAR SHEAR	11	
1	3- 21000-9	SCREW SKT. HD. CAP (10-32 X 1 00) CAM	101	458183-1	INSERT, ANVIL	10	
			80	690529-4	PLATE, FRONT SHEAR	9	
			79	691523-4	ANVIL	8	
			78	691532-3	BLADE, SLUG	7	
			77			6	
			76	463874-1	PLATE, ANVIL MOUNTING	5	
			75			4	
1	458109-1	WASHER, SPECIAL	74			3	
2	21017-2	SCR. DRIVE #2 X 19	73			2	
1	461264-1	PLATE, IDENTIFICATION	72	691531-6	CRIMPER, WIRE	1	
1	690603-1	SPRING, ASSIST	71				

TERM APPL SPEC 114-2078

CRIMPING DATA				THIS APPLICATOR WILL APPLY	
PAD LETTER	CRIMP HEIGHT	WIRE SIZE	WIRE STRIP LENGTH		
A	.085	10			62057-1
B	.069	12			62057-3
C	NOT USED				62057-5
D	NOT USED				
CRIMP WIRE	SIZE	TYPE	FEED		
	200	TL	760		
INSULATION RANGE	WIRE RANGE	APPLICATOR INSTRUCTION # 8031			
	12-10				
REMARKS AMPOMATOR DO NOT EXCEED 80 CPM WITH THIS APPLICATOR					

REV	DATE	BY	DESCRIPTION
N	0150-0506-02		
M	0150-7103-96		
L	0150-6882-96		
K	ECN A-866482		
J	ECN A-304971		
H	ECN A-238750		
G	ECN A163289		
F	REV PER ECN A-105788		
E	REV PER ECN		
D	REV PER ECN		
C	REV PER ECN		
B	REV PER ECN		
A	REV PER ECN		

REV	DATE	BY	DESCRIPTION
S	ECR-07-029745		
R	ECR-07-028815		
Q	ECR-06-004455		
P	ECN 6150-0227-04		
O	ECN 0150-0226-03		

AMP INCORPORATED HARRISBURG, PENNA.

LOC A C NO. 687748-1

SCALE NONE

HINGE BAR, E.F. (TAB LOK (RIGHT HAND))

CUSTOMER AND ASSEMBLY DRAWING

THIS DRAWING IS UNPUBLISHED
RELEASED FOR PUBLICATION
BY AMP INCORPORATED
ALL RIGHTS RESERVED
COPYRIGHT 2000
DIMENSIONS IN INCHES DO NOT SCALE PRINT
PRINT 666

687748-1