

REVISIONS					
REV	ECO	DESCRIPTION	DATE	BY	APPR
A1	-	NEW RELEASE	31AUG2017	JAH	
A2	-	ADDED NOTE #4 (PACKAGING)	15SEP2017	JAH	

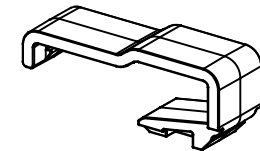
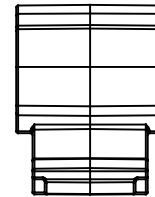
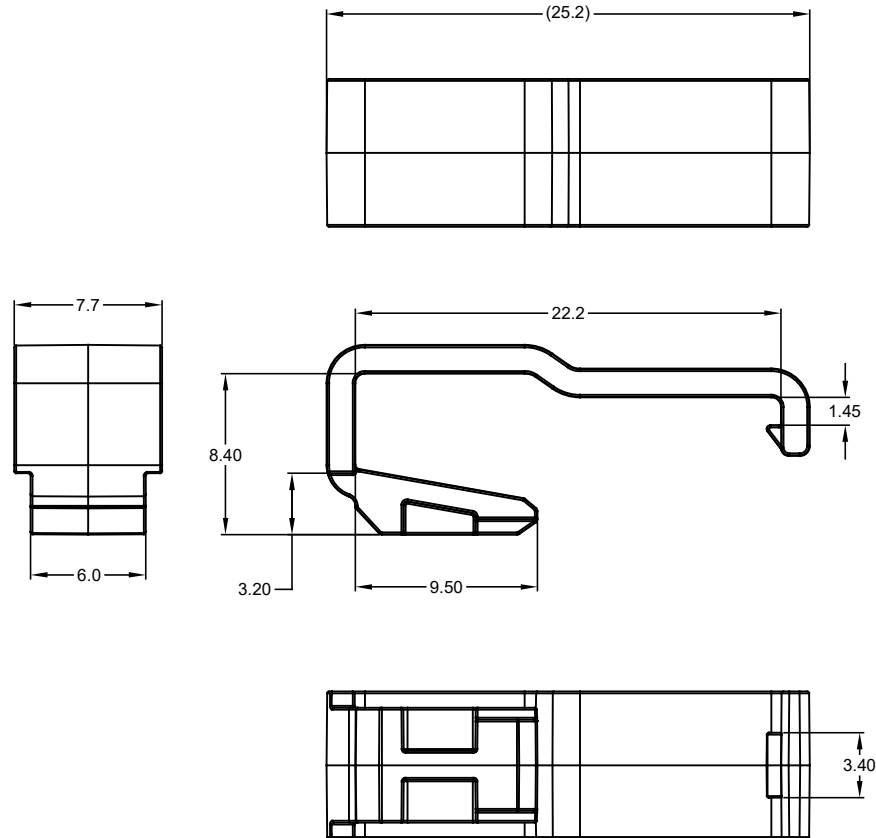

NOTES: UNLESS OTHERWISE SPECIFIED

- MATERIAL:
THERMOPLASTIC; COLOR: GREEN
- FOR USE WITH "AT" SERIES, 3 POSITION, FULLY MATED
PLUG AND RECEPTACLE SET.
- ALL DIMENSIONS ARE FOR REFERENCE USE ONLY.
- PARTS TO TO PACKAGED IN BAGS OF 1000 PIECES.

TITLE: CPA, AT SERIES, 3-POS, GREEN
 DWG NO: AT-3CPA-GRN
 REV: A2
 SH: 1
 OF: 1

AT-3CPA-GRN		DESCRIPTION		ITEM
QUANTITY	PART NUMBER	DESCRIPTION		ITEM
MATERIALS LIST				
<small>UNLESS OTHERWISE SPECIFIED:</small> 1) All dimensions are in metric (mm). 2) Tolerances are as follows: 1 PL DEC ±0.30 2 PL DEC ±0.15 3 PL DEC ±0.08 Fractions ±1/64 Angles ±1° 3) Note reference =		SIGNATURES DATE DRAWN: JAH 31AUG2017 CHECKED: ENGINEER: APPROVAL: CUSTOMER:		Amphenol Sine Systems - www.amphenol-sine.com 44724 Morley Drive Clinton Township, MI 48036 CPA, AT SERIES, 3-POS, GREEN
<small>MATERIAL SPECIFICATIONS:</small> PROCESS SPECIFICATIONS: NEXT ASSY:		<small>THIS DRAWING IS SUPPLIED FOR INFORMATION ONLY. DESIGN FEATURES, SPECIFICATIONS AND PERFORMANCE DATA SHOWN HEREON ARE THE PROPERTY OF THE AMPHENOL CORPORATION. NO RIGHTS OF REPRODUCTION ARE IMPLIED. ALL DIMENSIONS ARE SUBJECT TO NORMAL MANUFACTURING VARIATIONS.</small>		
SIZE: B C- TYPE: DWG NO: AT-3CPA-GRN REVISION: A2 SCALE: NONE SHEET 1 OF 1				