

THIS DRAWING IS A CONTROLLED DOCUMENT FOR SOURIAU USA, INC. CONTACT THE DOCUMENT CONTROL CENTER FOR THE LATEST REVISION.

C

B

THE INFORMATION CONTAINED IN THIS DRAWING IS CONFIDENTIAL AND MAY NOT BE DISCLOSED WITHOUT WRITTEN CONSENT FROM SOURIAU USA, INC.

DWG. NO. **SC52453**

PLATING TABLE	
CATALOG NUMBER	PLATE PER SOURIAU SPEC F450
LRM16W - 2F51	TYPE 51 GOLD OVER SILVER
LRM16W - 2F74	TYPE 74 - RHODIUM OVER SILVER
LRM16W - 2DB6	TYPE DB6-HARD GOLD OVER SOFT GOLD OVER COPPER
LRM16W - 2DE5	TYPE DE5 GOLD OVER COPPER
LRM16W - 2F63	TYPE F63 GOLD OVER SILVER
LRM16W - 2D29	TYPE D29-HARD GOLD OVER SILVER

NOTES:
 COLOR CODE:
 1 BLUE DENOTES #16 SIZE WIRE BARREL.
 2 RED DENOTES # 20 SIZE MATING END.
 MATERIAL:
 BRASS
 FINISH:
 SEE TABLE

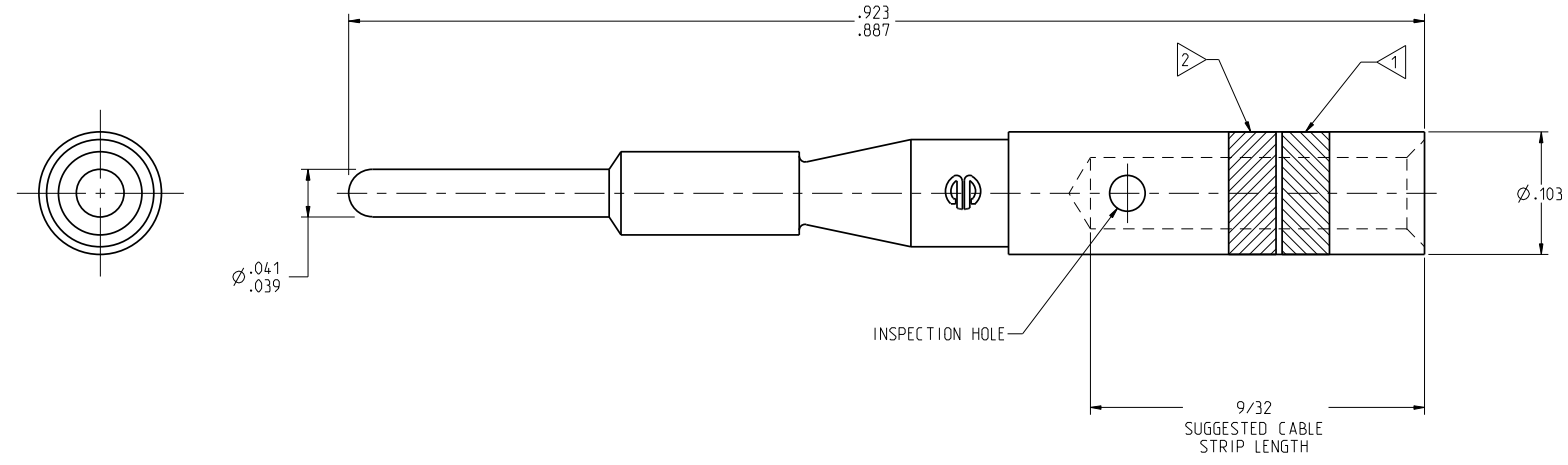

ACCOMMODATES	CRIMPING TOOL	EXTRACTION TOOL
#16, 18, 20 PER MIL-W-16878 TYPE E MIL-W-5086 MIL-W-27300	M10S TOOL S-7-1 DIE SET SL-44 POSITIONER	RX20-24

P	REVISED PER ECN10186	GRB 01-18-07	FLR 01-18-07
13	ADDED SPACE BETWEEN ADJACENT COLOR BAND (ECN 161)	ZD 10-08-81	DN 10-08-81
12	LRM16W-2F72-F72 RHODIUM NICKEL OVER GOLD REMOVED FROM PLATING TABLE (ECB 3613)	LH 06-10-76	SFP 09-03-76
11	LRM16W-2F72 ADDED (ECB2379)	MRP 09-03-76	SFP 09-03-76
10	S-7-1 DIE SET WAS S-7 DIE SET (ECB 2355)	MRT 04-07-76	DL 04-07-76
9	LRM16W-2D29 ADDED (ECB2246)	HE DL 08-07-75	DL 08-07-75
8	F63 PLATING ADDED (ECB 1987)	HC 06-27-73	DE 006-27-73
7	DES PLATING ADDED (ECB 1695)	RW V 05-30-72	RW V 05-30-72
6	ADDED COLOR CODE (ECB1061)	PJB RW V 03-10-70	RW V 03-10-70
5	ADDED TYPE DB4 TO PLATING TABLE (ECB1014)	JC 16-11-69	RVV 16-11-69
4	ADDED TYPE F74 TO PLATING (EC338500)	RLC 09-29-66	RLC 09-29-66
3	USED IN SMOOTH BANTAM NOTE ADDED	SM AFR 10-06-64	AFR 10-06-64
2	MS3190, MS3192, REMOVED (EC28252)	TMM 06-19-63	TMM 06-19-63
1	TABLE ADDED (EC27717)	TMM 03-29-63	WNT 03-29-63
REV	ECN NUMBER	BY DATE	CHKD DATE

REFERENCE : FD52452

LINEAR MEASURE:	<input type="checkbox"/> INCH <input type="checkbox"/> INCH (mm)
THIRD ANGLE PROJECTION	
TOLERANCES UNLESS OTHERWISE SPECIFIED	
No. OF PLACES	INCH (mm)
ONE PLACE	±.1 (±.3)
TWO PLACES	±.02 (±0.5)
THREE PLACES	±.010 (±0.25)
ANGLES ±1°	

DRAWING TITLE
SMOOTH CONTACT HYFEN PIN

CAT NO. **LRM16W-2 (SEE TABLE)**

CAGE NO: 09922 SIZE: C

CUSTOMER

www.souriau.com

INTERPRET THIS DRAWING IN ACCORDANCE WITH ASME Y14.5M - 1994.

DRAWN:	GRB	01-18-07
CHKD:	FLR	01-18-07
DSGN:	GRB	01-18-07
MFG:	RR	01-18-07
QC:	DK	01-18-07
DRAWING SCALE: 10:1		
DRAWING NO.	REV	
SC52453	P	
1 OF 1		

D

C

B

A

4

3

2

1

PRO-E